



# BUILD YOUR DECK *in* FIVE EASY STEPS







## BUILT FOR LIVING

*Engineering what's next in outdoor living®* isn't just a motto; it's our mission. More than 20 years ago, Trex revolutionized the industry by introducing a high-performance, eco-friendly alternative to wood decking. Today, we're proud to offer *more ways than ever* to live outdoors—whether you're building on a budget or seeing your biggest, boldest idea through. It's never been easier to make the Trex® decision that's right for you.

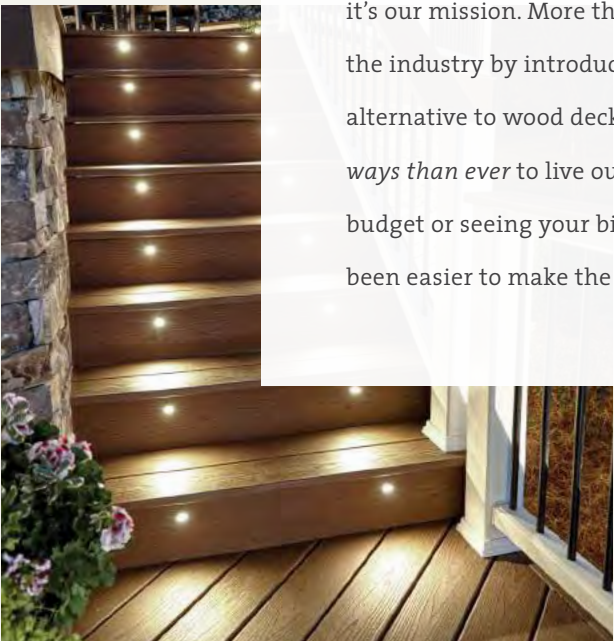
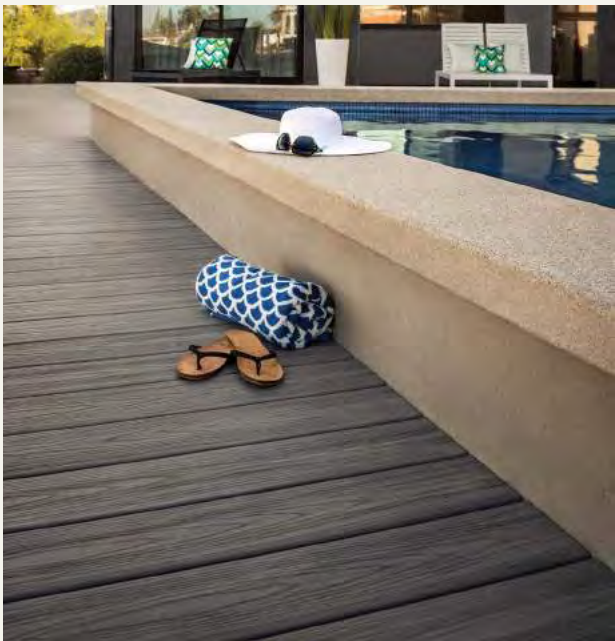





decking: Enhance in Foggy Wharf  
railing: Transcend in Classic White with round  
aluminum balusters in Charcoal Black  
featuring: Outdoor Furniture

# YOUR DECKING CHECKLIST

In just five steps, go from having a bad case of deck envy to being 100% deck ready.

1

## DETERMINE MATERIALS, SIZE & SHAPE

The what and the how of building the deck of your dreams. Plan accordingly.

2

## CONSIDER THE SUBSTRUCTURE

Find out why our steel framing system results in long-lasting stability and support.

3

## CHOOSE YOUR DECKING

Explore a comprehensive range of easy, low-maintenance options.

4

## CHOOSE YOUR RAILING

The signifier of great taste. Pick a pre-styled combo or mix and match railing components for a custom look.

5

## ADD THE EXTRAS

Complete your outdoor area with furniture, lighting, kitchens and shade.



# Materials, SIZE & shape

Once you know how you want to use your deck, you'll be able to determine the best materials, size and shape. Ask yourself these questions to see where you stand.

1

Do you have the time to maintain a wood deck?

2

Will you use an existing substructure or build a new one?

3

Do you expect your deck to retain its vibrancy, year after year?

4

Do you envision a curved or angular deck?

?

5

Will there be more than one level?

6

Will there be multiple exits and entrances?

7

Do you want room for a grill or dining area?

8

How will you light your deck?





# THE LOOK OF WOOD

WITHOUT  
ALL THE  
WORRY

You could build your deck with any number of materials.

*But why would you, when Trex® decking and railing consistently outdeck wood and the wannabes?*

## TREX WILL



*Beautifully withstand  
years of sun, sleet & snow*  
**HIGH-PERFORMANCE  
TECHNOLOGY**



*Clean easily  
with soap & water*  
**LOW-MAINTENANCE  
PROPRIETARY SHELL**



*Make good on its promises*  
**25-YEAR LIMITED  
RESIDENTIAL  
AND FADE & STAIN  
WARRANTIES**



*Let forestfuls of trees  
grow and grow*  
**MADE OF 95%  
RECYCLED MATERIALS  
IN THE USA**

## TREX WON'T

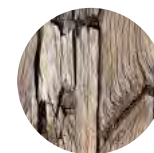

*Rot, warp or splinter*  
**UNLIKE WOOD**

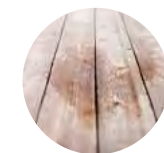

*Fade or stain*  
**UNLIKE WOOD**



*Need seasonal painting,  
sealing or staining*  
**UNLIKE WOOD**



*Become food for termites*  
**UNLIKE WOOD**



# Trex® Deck Designs

When planning your outdoor space, it's important to make sure your deck has exactly that—space.

... Download our most popular layouts and materials lists at [trex.com/plans](https://www.trex.com/plans)

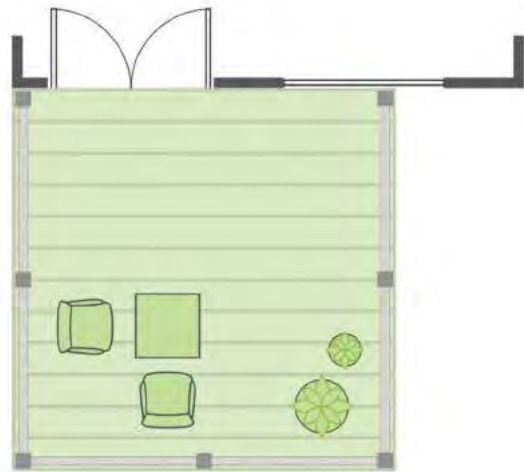

## Rectangle Deck

- » Offers room for outdoor eating and grilling
- » Works well with smaller homes, rooftops or side yards
- » Standard shape in five sizes makes for a versatile, multi-use space

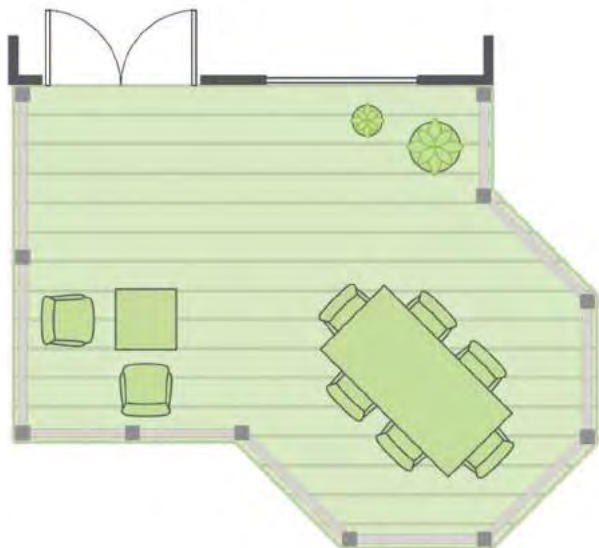

## Overlook Deck

- » Provides distinct spaces so you can get the most from your deck
- » Works well with smaller to mid-sized homes with gardens or extended views
- » Multi-side add-on makes for a cozy sitting or dining area

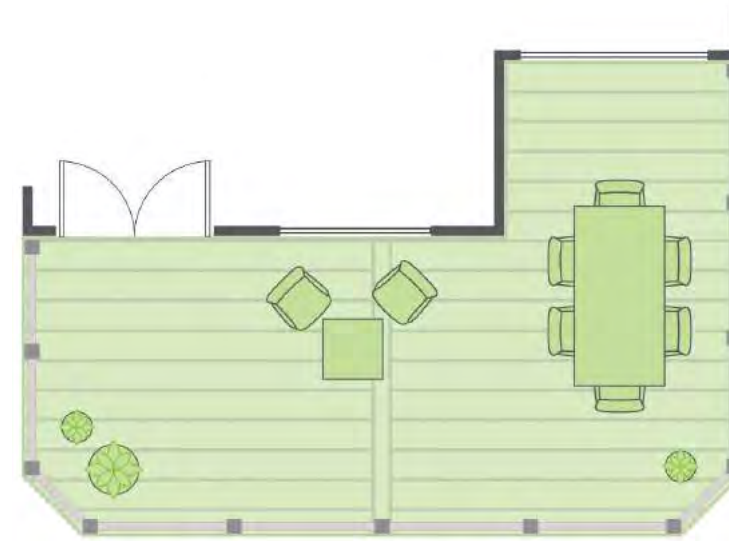

## Beveled-Edge Deck

- » Allows for large sitting area or several smaller spaces
- » Works well with smaller to mid-sized homes of contemporary design
- » Rounded corners open the view and decor possibilities

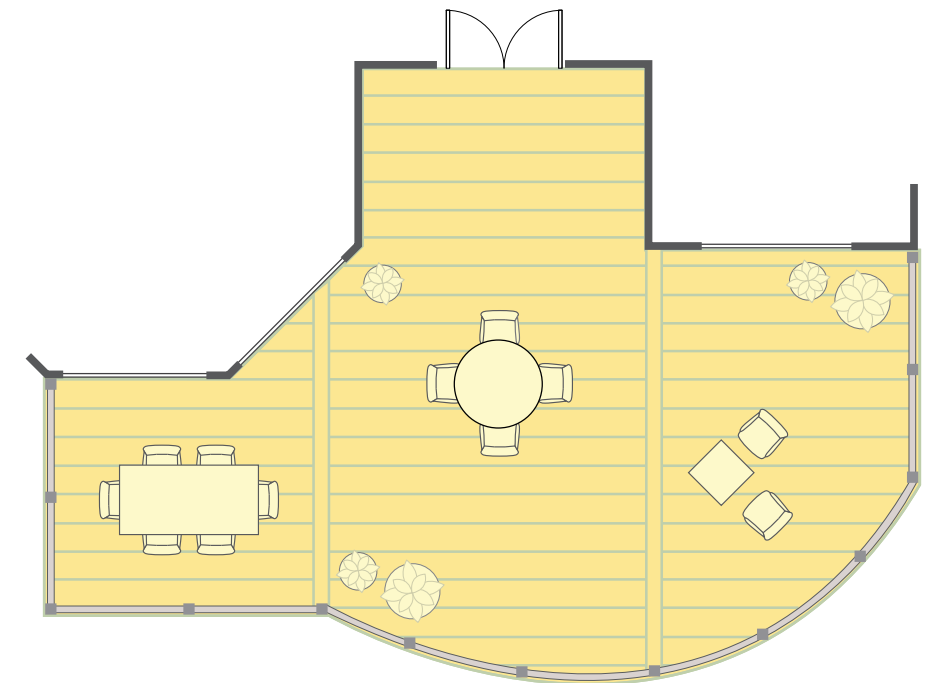

## Custom Deck

Have a space that defies our deck plans?

Contact a local **TrexPro®** for a custom approach.

...

Find one at [trex.com/findapro](https://www.trex.com/findapro)



## Doing it yourself?

Find downloadable guides, how-to videos and more at [trex.com/DIY](https://www.trex.com/DIY)

## Consider the SUBSTRUCTURE

Trex Elevations® is our alternative to splitting, warping and shifting wood substructures. This system of beams, joists and tracks fortifies the structure down below, resulting in an even surface above.

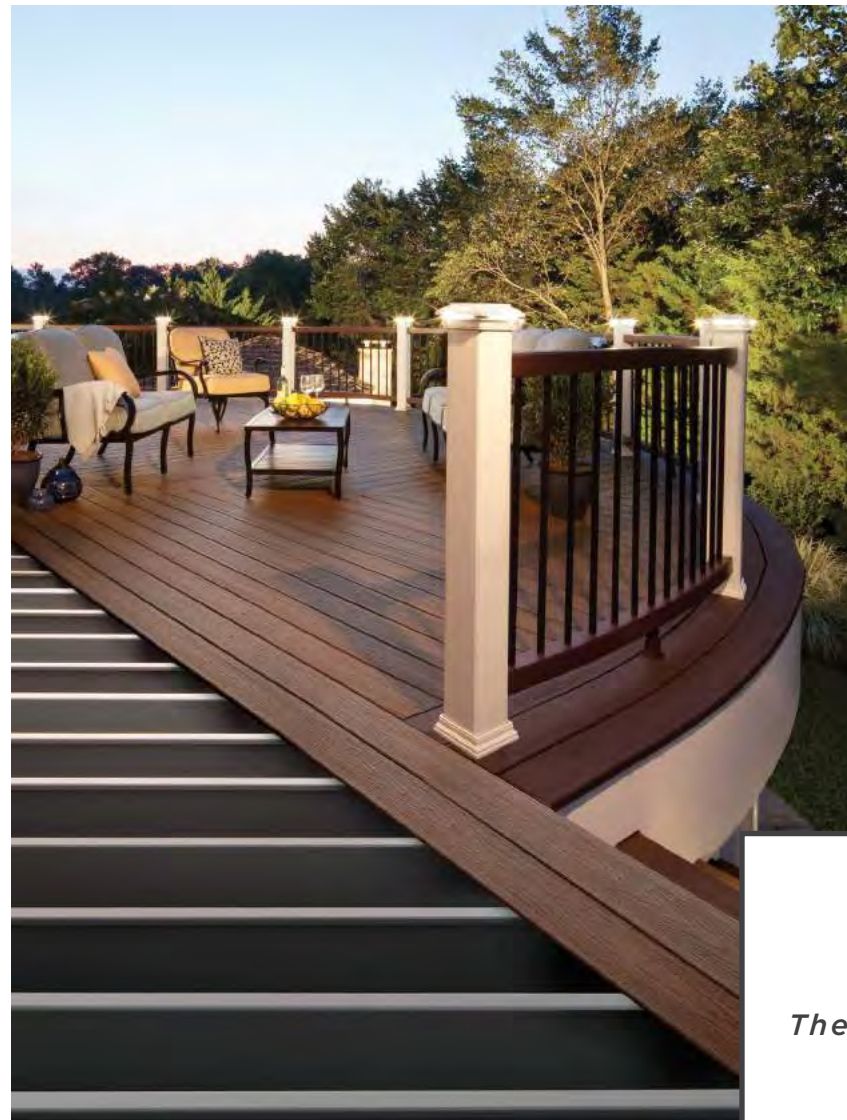

### STRONGER

Triple-coated steel offers consistency, durability and reliability that treated wood can't.

### STRAIGHTER

Precision engineering ensures surfaces remain flat over time.

### SAFER

Rot- and termite-proof steel is chemical-free and outlasts wood.

### SMARTER

Contains a minimum of 25% recycled steel and is a 100% renewable resource.

**Trex**Elevations®  
STEEL DECK FRAMING

*The only deck frame that can stand up*

.....  
**TO THE ELEMENTS**  
.....

## CHOOSE *your* DECKING

Vibrant shades of possibility give you unmatched control over the design of your deck. Turn the page to find the Trex® decking color and collection that best suit your home—and your budget.



### DISCOVER YOUR STYLE

with a range of modest and luxurious options



### CHOOSE YOUR HUE

with our Color Selector tool at [trex.com/colors](https://trex.com/colors)



### PRICE IT OUT

with our Cost Calculator tool at [trex.com/costs](https://trex.com/costs)



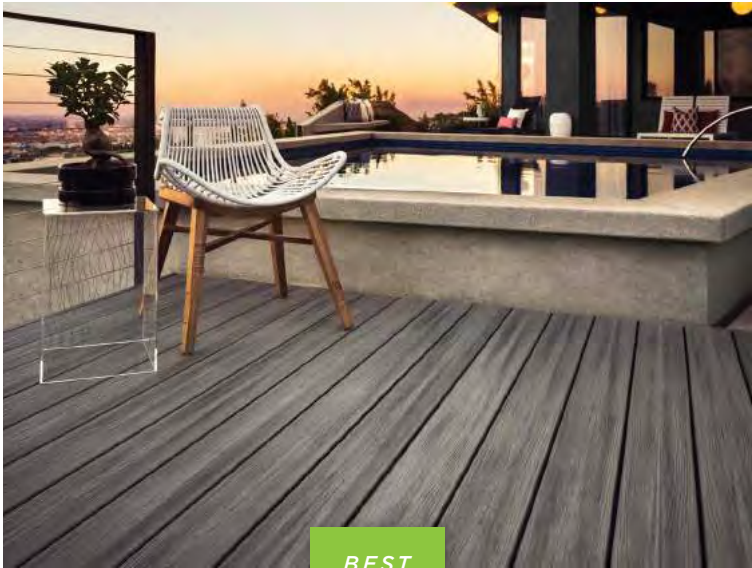

BEST

**Trex**Transcend®  
TROPICALS

Elevated aesthetics paired with  
the highest level of performance.

\$\$\$  25 ★★★★★

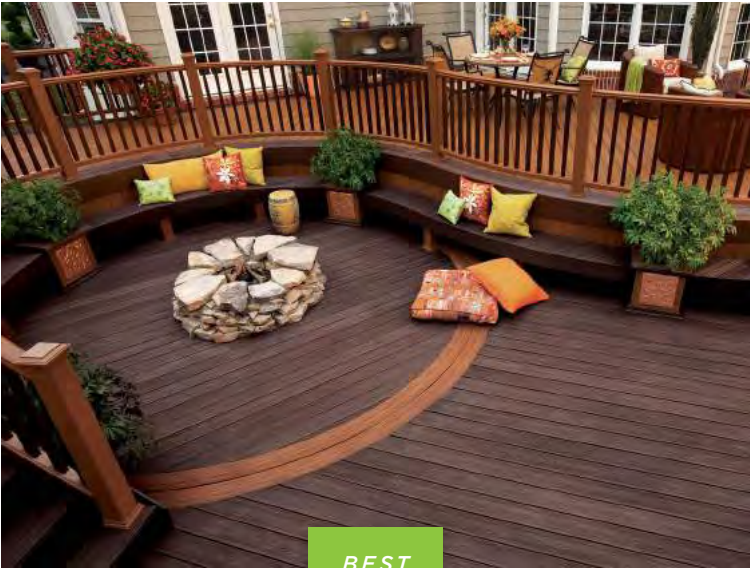

BEST

**Trex**Transcend®  
EARTH TONES

A classic look for  
uncompromising homes.

\$\$\$  25 ★★★★★



BETTER

**Trex**Select®  
EARTH TONES

The perfect pairing of price  
and minimal maintenance.

\$\$  25 ★★



BETTER

**Trex**Enhance®  
NATURALS

The beauty of wood with  
the ease of composite.

\$\$  25 ★



GOOD

**Trex**Enhance®  
BASICS

Priced to put the pressure  
on treated lumber.

\$  25 ★

GREYS



Island Mist



Gravel Path



Pebble Grey

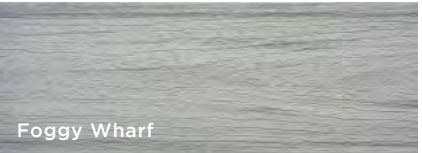

Foggy Wharf

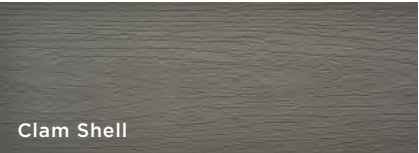

Clam Shell

BROWNS



Tiki Torch



Rope Swing



Winchester Grey



Rocky Harbor

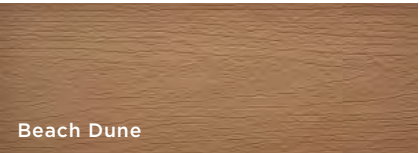

Beach Dune

REDS



Havana Gold

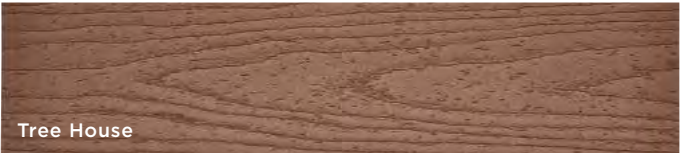

Tree House



Saddle



Toasted Sand

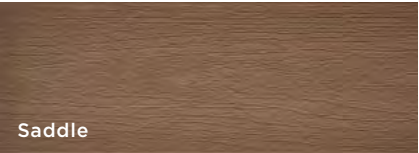

Saddle



Spiced Rum

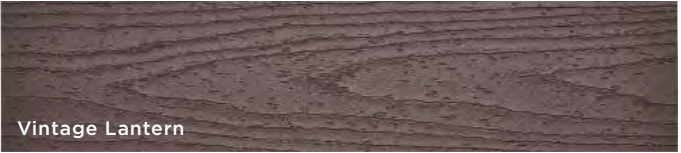

Vintage Lantern



Woodland Brown



Coastal Bluff



Lava Rock

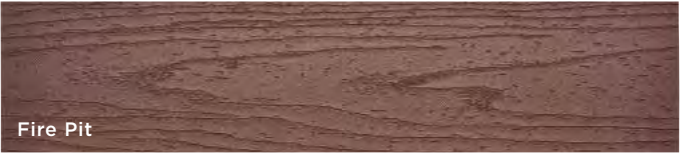

Fire Pit



Madeira



Sunset Cove

Sample any and  
every color at  
[trex.com/shop](https://trex.com/shop)





**Trex**Transcend®

TROPICALS

*ELEVATED AESTHETICS PAIRED WITH  
THE HIGHEST LEVEL OF PERFORMANCE*

Big, bold notions of outdoor living come to life with Trex Transcend® Tropicals. Our premium line combines second-to-none performance and hassle-free maintenance with the beauty of exotic teak and ipe. The result? Naturally streaked hues that make a vibrant statement.

A luxurious  
look that lasts



Rich,  
multi-tonal  
colors

BOARD PROFILES

Square  
edge



Grooved  
edge



Curveable boards  
for endless design  
possibilities

Use **Trex Hideaway® Hidden  
Fastening System** for a clean,  
fastener-free appearance

AVAILABLE COLORS:

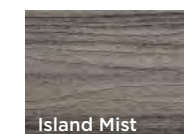

Island Mist

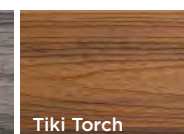

Tiki Torch

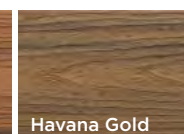

Havana Gold

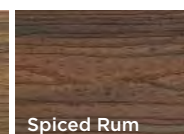

Spiced Rum

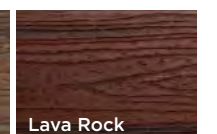

Lava Rock

decking: Transcend in Havana Gold  
railing: Signature Mesh in Bronze  
featuring: Hidden Fasteners and Outdoor Lighting





Photo © 2019 Scripps Networks, LLC.  
Used with permission; all rights reserved.

**Trex**Transcend®

EARTH TONES

A CLASSIC LOOK FOR  
UNCOMPROMISING HOMES

Like its tropical counterpart, Trex Transcend® Earth Tones give homeowners the freedom and confidence to design to every curve of the imagination. But these premium composite boards stand apart with a monochromatic color palette as timeless as its inspiration: nature itself.

A luxurious  
look that lasts



Consistent  
monochromatic  
color, end to end

BOARD PROFILES

Square  
edge



Grooved  
edge



Curveable boards  
for endless design  
possibilities

Use **Trex Hideaway® Hidden  
Fastening System** for a clean,  
fastener-free appearance

AVAILABLE COLORS:



**Trex® Cladding™**  
A new side to Trex Transcend

Learn about the architects' choice in  
elegant, worry-free residential armor at  
[trex.com/cladding](https://trex.com/cladding)

decking: Transcend in Gravel Path  
featuring: Hidden Fasteners, Pergola  
and Outdoor Lighting





BEST  
BETTER  
GOOD

# Trex Select®

EARTH TONES

*THE PERFECT PAIRING OF PRICE  
AND MINIMAL MAINTENANCE*

Durable and inviting, Trex Select® brings consistent performance to your home—and peace of mind. Skip the stain aisle and, instead, live life outdoors with the simple choice in composite decking.

Built for living,  
not maintaining



Wide range  
of traditional,  
complementary  
colors

#### BOARD PROFILES

Square  
edge



Grooved  
edge



Sturdy enough  
to handle curves

Use **Trex Hideaway® Hidden Fastening System** for a clean, fastener-free appearance

#### AVAILABLE COLORS:

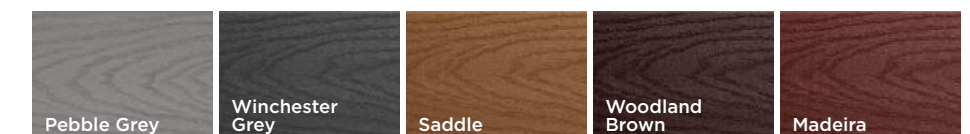

decking: Select in Pebble Grey  
railing: Select in Classic White with round aluminum balusters in Charcoal Black  
featuring: Hidden Fasteners, Cocktail Rail and Outdoor Furniture





GOOD BETTER BEST

# Trex Enhance®

NATURALS

THE BEAUTY OF WOOD WITH  
THE EASE OF COMPOSITE

With its authentic wood-grain appearance, Trex Enhance® Naturals offer all the charm and none of the trouble of pressure-treated lumber. Imagine enjoying the very same multi-tonal streaking now and 25 years from now without costly, continual upkeep.

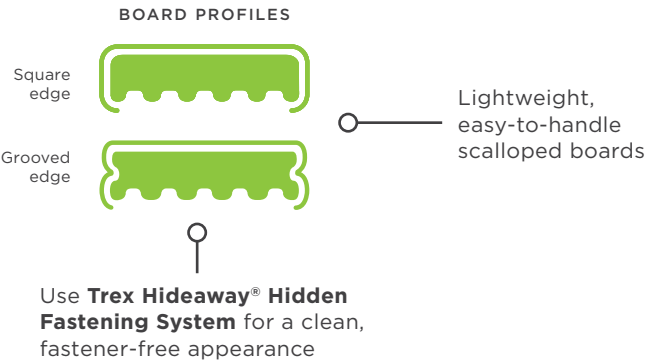

AVAILABLE COLORS:



decking: Enhance in Rocky Harbor  
railing: Transcend in Classic White with round aluminum balusters in Charcoal Black  
featuring: Hidden Fasteners and Outdoor Lighting





**Trex**Enhance®

BASICS

*PRICED TO PUT THE PRESSURE  
ON TREATED LUMBER*

Once and for all, Trex has engineered cost out of the equation with our latest collection of easy-to-build, easy-to-maintain decking. Trex Enhance® Basics meld the durability of composite with the affordability of wood, resulting in long-lasting, worry-free decking.

Perfect for DIYers:  
no specialty tools  
required



No sanding,  
no sealing...ever

BOARD PROFILES

Square  
edge



Grooved  
edge



Lightweight,  
easy-to-handle  
scalloped boards

Use **Trex Hideaway® Hidden Fastening System** for a clean, fastener-free appearance

AVAILABLE COLORS:

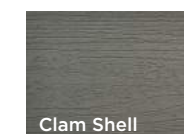

Clam Shell

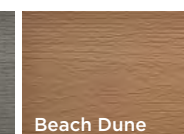

Beach Dune

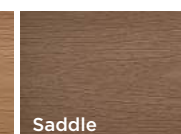

Saddle



---

STEP 4

# CHOOSE *your* RAILING

---

When people look at your deck, they'll see the railing before anything else. Which is why a picture-perfect deck means selecting railing that signifies your style—whether you're a modern minimalist or traditional to the core.



**SHOW OFF YOUR SURROUNDINGS**  
with sleek, sturdy rails that frame your deck and the view beyond it



**ELIMINATE THE GUESSWORK**  
with pre-designed railing kits—available in all our most popular combinations



**INNOVATE WITHOUT WASTE OR WORRY**  
with recycled materials backed by a 25-Year Limited Residential warranty



**Trex**Signature®  
RAILING

Effortless style,  
exceptional strength.

**Trex**Transcend®  
RAILING

Quick-and-easy customization.

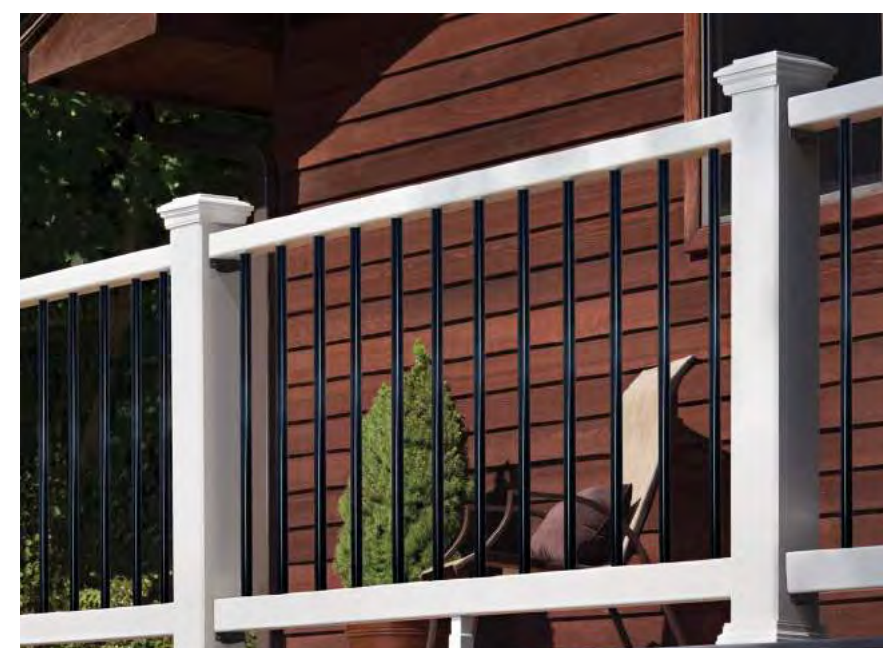

**Trex**Select®  
RAILING

The simple choice for your backyard.



decking: Transcend in Havana Gold  
railing: Signature Rod Rail in Charcoal Black  
featuring: Hidden Fasteners

# Trex Signature®

RAILING

*EFFORTLESS STYLE, EXCEPTIONAL STRENGTH*

With the right railing, even the perfect view becomes elevated.  
Frame yours with Trex Signature, now available in four styles.



# Give it YOUR SIGNATURE

Incredibly sleek and remarkably strong, Trex Signature® celebrates the refined beauty of negative space. Choose from four infill options to complement powder-coated aluminum rails and posts.



## TREX SIGNATURE® ALUMINUM RAILING

Traditional balusters pair stunning lines with guaranteed durability.

AVAILABLE COLORS:



## TREX SIGNATURE® MESH RAILING

Stainless-steel crosshatching lends a modern, industrial edge.

AVAILABLE COLORS:

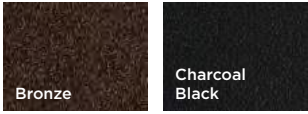

## TREX SIGNATURE® ROD RAIL

Horizontal infill rods deliver high-end design to any outdoor space.

AVAILABLE COLOR COMBINATIONS  
OF RAILS AND RODS:



## TREX SIGNATURE® GLASS RAILING

The ultimate in clean and contemporary: tempered glass (and sweeping views).

AVAILABLE COLORS:





decking: Transcend in Spiced Rum  
railing: Transcend in Vintage Lantern with  
round aluminum balusters in Charcoal Black



**Trex**Transcend®

RAILING

QUICK-AND-EASY CUSTOMIZATION

railing: Select in Classic White with round  
aluminum balusters in Charcoal Black



**Trex**Select®

RAILING

THE SIMPLE CHOICE FOR YOUR BACKYARD

When you want the freedom to mix and match balusters, rails and posts, you want Trex Transcend®. As strong and sturdy as its namesake decking, Transcend puts every color combination within reach. Style your own or eliminate the guesswork with pre-designed kits.



AVAILABLE COLORS:



Why overthink what works? Crisp, safe and effective, Trex Select® railing streamlines the design process by combining white composite rails and posts with black aluminum balusters. Perfect for every deck, every budget.

AVAILABLE COLOR COMBINATION:





A SHORTCUT TO STYLE

## Decking & Railing Duos

Choosing railing that complements your decking has never been easier. Every Trex® decking color comes with three pre-designed railings that go with it, along with a complete materials list and an alphanumeric code that makes ordering easy.

**Take a look at the three options we curated for Spiced Rum decking.**

... To see our railing duos for every color, visit [trex.com/duos](https://trex.com/duos)

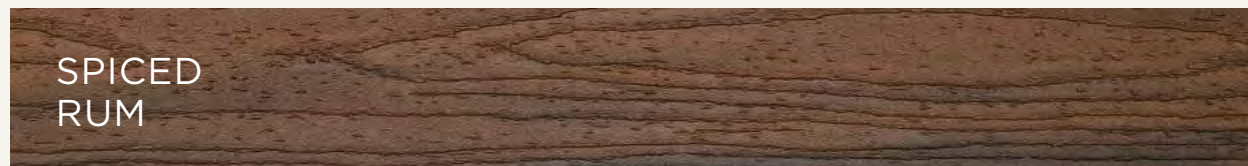

SR-1

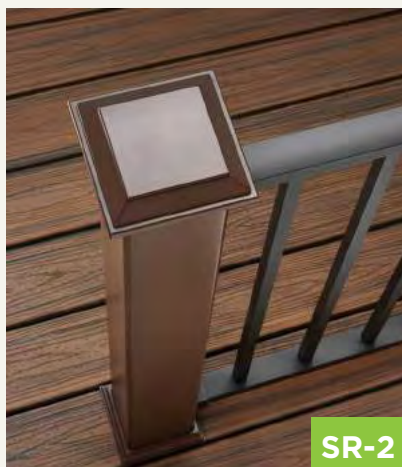

SR-2



SR-3

Classic White rails with Spiced Rum cocktail rail, Classic White posts and Classic White composite balusters



SR-1



SR-2

Charcoal Black aluminum rails, Vintage Lantern posts and Charcoal Black square aluminum balusters

Vintage Lantern rails, Classic White posts and Charcoal Black round aluminum balusters



SR-3



# The anatomy of RAILING

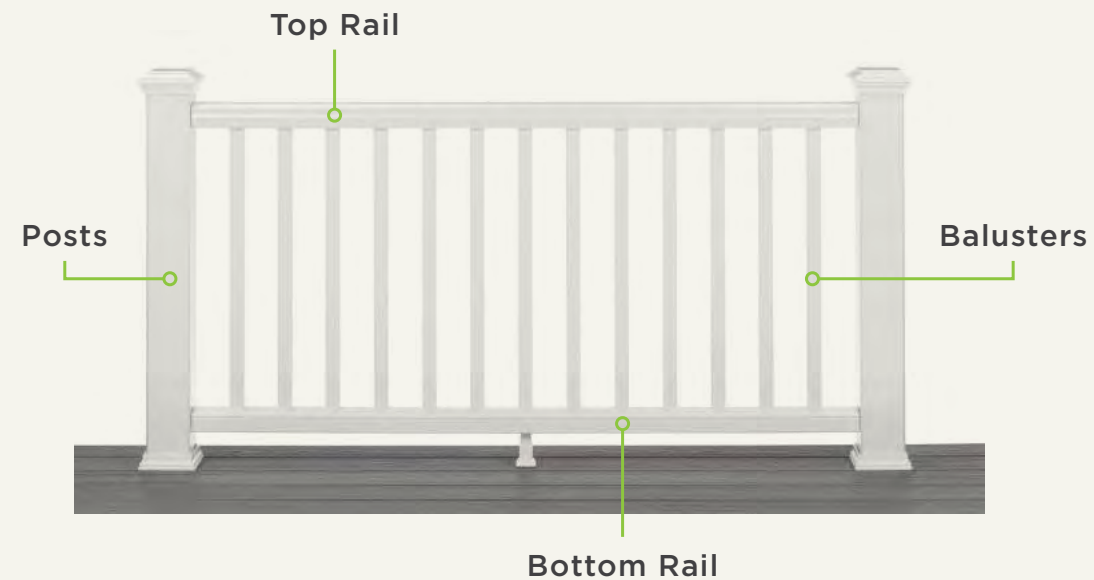

## Posts

Vertical poles that can be outfitted with caps and skirts.

AVAILABLE IN ALL COLORS



## Rails

Top and bottom rails designed to keep railing straight and beautiful.

AVAILABLE IN ALL COLORS



## Balusters

Vertical columns that maintain space and safety.

AVAILABLE IN ALL COLORS



## Cocktail Rail (Optional)

Deck board on a Transcend universal top rail or Signature rail to create a flat surface.



AVAILABLE IN ALL TREX TRANSCEND AND SELECT DECKING COLORS

TrexPro® contractors know custom railing. If you prefer a look that's truly unique, find a professional at [trex.com/findapro](https://trex.com/findapro)

## ADD *the* EXTRAS

Before you luxuriate on your new deck, you're going to need a few add-ons. Think seats, lighting and shade. The good news is that our extras are just as durable and design-minded as our decking and railing.

*fun &*  
**GAMES**



*energy-saving*  
**LIGHTING**



**PERGOLA**



*under-deck* **DRAINAGE**



*outdoor* **COOKING**



**FURNITURE**  
*for every style*







## Trex® Outdoor Lighting™

### JUST IMAGINE WHAT PROPER LIGHTING COULD BRING TO THE PARTY

With the right light, an outdoor space goes from invisible to inviting. That's why Trex has expanded our soft white lighting to cover more ground—from post cap lights and recessed deck lights to stair risers and more.

#### DECK LIGHTING

Ours seamlessly integrates into rails, risers, treads and posts for easy, elegant wayfinding.

SHOP [TREX.COM/LIGHTING](https://www.trex.com/lighting)

Order today or find a retailer  
near you on our website.



## Trex® Fascia

### BEAUTY FROM EVERY ANGLE

With Trex® Fascia, your outdoor space stands out, side on. Engineered to retain its rich color just as long as your deck surface, our fascia adds wonderful depth and dimension to your design.

#### GIVE YOUR DECK AN EDGE

Try Universal White Fascia for a crisp, clean finish.

... More edging ideas at [trex.com/fascia](https://www.trex.com/fascia)

#### AVAILABLE IN ALL DECKING COLORS:



Universal  
White Fascia





**Trex® Pergola™**

#### ABOVE AND BEYOND

Trex® Pergola™ keeps outdoor living from feeling so...outdoors. Add a customizable pergola to your sun-soaked space and get a shady, sturdy retreat that's virtually upkeep-free.

#### COOLER BY A MILE

Add a ShadeTree® Canopy System for a pop of color and smart sun protection. Retractable canopies available in AirFlow Mesh or Sunbrella® outdoor fabric at [trexpergola.com](https://www.trexpergola.com)



Trex® Pergola™ products are manufactured and sold by Home & Leisure, Inc., d/b/a/ Structureworks Fabrication, under a Trademark License Agreement with Trex Company, Inc. A 25-Year Limited Residential Warranty and a 10-Year Limited Commercial Warranty provided by the manufacturer. Sunbrella® is a registered trademark of Glen Raven, Inc. ShadeTree® Canopy is a registered trademark of Shade Tree Inc.



**Trex® Outdoor Kitchens™**

#### HIDE AND CHIC

Mix the comforts of your indoor space with the natural beauty of your outdoor space with Trex® Outdoor Kitchens™. Stainless steel cabinetry brings both style and utility to your yard.

#### STYLE MEETS DURABILITY

Protect your cabinetry from even the harshest elements with a powder-coated finish. Choose from a range of unique colors and designs at [trex-outdoorkitchens.com](https://www.trex-outdoorkitchens.com)



Trex® Outdoor Kitchens™ is manufactured and sold by CT Acquisitions LLC., under a Trademark Agreement with Trex Company, Inc. A Limited Warranty is provided by the manufacturer.





## Trex® Spiral Stairs™

### GO FROM SPACE-POOR TO SPACE-PROUD

Trex® Spiral Stairs™ offer all of the space-saving advantages of traditional spiral staircases but with Trex style, strength and simplicity.

### STEP UP AND STAND OUT

Each step tread can be capped with Trex composite decking to match—or contrast—your deck color.

... Settled on spiral? Download a blueprint at [trexspiralstairs.com](http://trexspiralstairs.com)



Trex® Spiral Stairs™ are manufactured and sold by M. Cohen and Sons, Inc., d/b/a The Iron Shop, under a Trademark License Agreement with Trex Company, Inc. A 25-year Limited Residential Warranty is provided by the manufacturer.



## Trex® RainEscape®

DECK DRAINAGE SYSTEM

### OUTWIT THE ELEMENTS

The unique Trex® RainEscape® under-deck drainage system keeps rain, spills and snow melt from dripping through the decking boards above, creating a dry room below.

... Now available in brown and black. See all the options at [trexrainscape.com](http://trexrainscape.com)

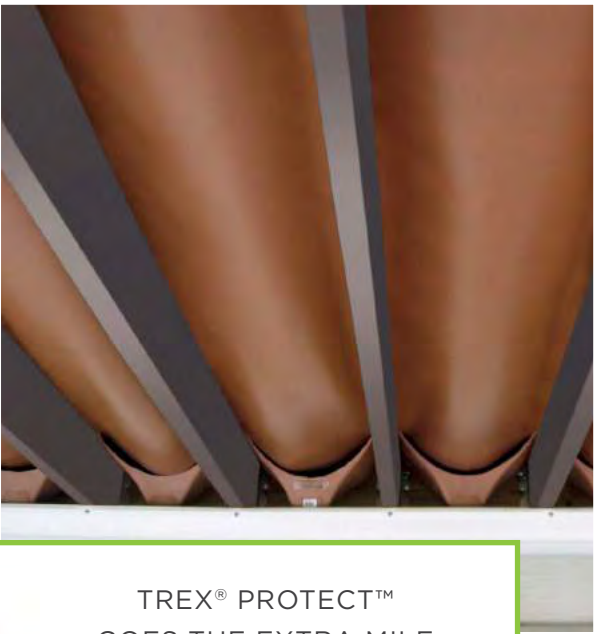

### TREX® PROTECT™ GOES THE EXTRA MILE

Shield the vulnerable components of your deck from moisture with Trex Protect, a non-skid, self-adhesive deck flashing tape.



Trex® RainEscape® products are manufactured and sold by Dri-Deck Enterprises, LLC under a Trademark License Agreement with Trex Company, Inc. RainEscape® is a federally registered trademark of Dri-Deck Enterprises, LLC. A 20-Year Limited Warranty is provided by the manufacturer.





## Trex® Outdoor Furniture™

### DEEP-SEATED BEAUTY

Each of our comfortable, durable and sustainable pieces feature an ergonomic design, superbly crafted with a splinter-free finish.

### WELL ROOTED

Trex—in partnership with *Trees for the Future*—plants a tree with each piece of furniture ordered.

... Learn more at [trexfurniture.com](https://www.trex.com/outdoor-furniture)



## Trex® Outdoor Fire & Water™

### INNOVATE YOUR SPACE

Welcome the beauty of the natural elements into your outdoor living space with fire and water features that push the limits of design and engineering.

### AN ELEMENTAL OASIS

Turn up the heat when entertaining with fire pits, tables and pots. Or, give your yard a touch of luxury with elegant water features.

... Learn more at [trexoutdoorfireandwater.com](https://www.trex.com/outdoor-fire-and-water)

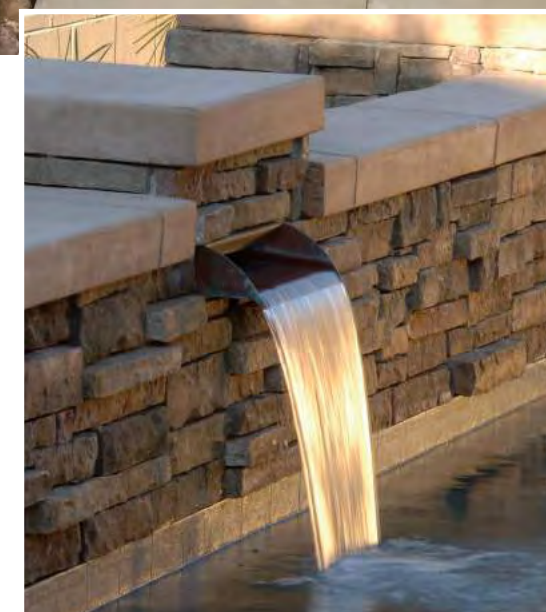



PLAY FOR KEEPS

Regulation-sized and surfaced, our durable cornhole set comes with eight resin-filled bags that withstand the elements, too.

●●● Learn more at [trex.com/cornhole](https://www.trex.com/cornhole)

Choose from a range of decorative and durable patterns to add privacy, utility and dimension deckside.

●●● Learn more at [trex.com/lattice](https://www.trex.com/lattice)

Trex® Cornhole™ is manufactured and sold by IPG Global Marketing under a Trademark License Agreement with Trex Company, Inc. A 1-year Limited Warranty is provided by the manufacturer for the boards, and a 30-day Limited Warranty provided by the manufacturer for the bags.

Trex® LatticeWorks™ is manufactured and sold by Rhea Products, Inc. d/b/a Acurio Latticeworks under a Trademark License Agreement with Trex Company, Inc. A 12-Year Limited Warranty is provided by the manufacturer.

Trex Elevations®

COMPONENT	DESCRIPTION	ITEM NUMBER
FRAMING COMPONENTS		
Track <i>Actual dimensions: 1.25 in x 8.25 in x 12 ft / 16 ft / 20 ft (31 mm x 209 mm x 365 cm / 487 cm / 609 cm)</i>		1.25 in x 8.25 in x 12 ft—Track 1.25 in x 8.25 in x 16 ft—Track 1.25 in x 8.25 in x 20 ft—Track CG0Q0812ET60 CG0Q0816ET60 CG0Q0820ET60
Beam <i>Actual dimensions: 2.125 in x 8.25 in x 12 ft / 16 ft / 20 ft (53 mm x 209 mm x 365 cm / 487 cm / 609 cm)</i>		2.125 in x 8.25 in x 12 ft—Beam 2.125 in x 8.25 in x 16 ft—Beam 2.125 in x 8.25 in x 20 ft—Beam CG020812EB20 CG020816EB20 CG020820EB20
Joist <i>Actual dimensions: 1.625 in x 8 in x 12 ft / 16 ft / 20 ft (41 mm x 203 mm x 365 cm / 487 cm / 609 cm) Additional lengths are available by special order.</i>		1.625 in x 8 in x 12 ft—Joist 1.625 in x 8 in x 16 ft—Joist 1.625 in x 8 in x 20 ft—Joist CG020812EJ50 CG020816EJ50 CG020820EJ50
Beam End Cap <i>Actual dimensions: 2.125 in x 8.125 in (53 mm x 206 mm)</i>		2.125 in x 8.125 in—Beam End Cap (40/box) ELVENDCAP40
Adjustable Mid-Span Block <i>Actual dimensions: 4 in x 9.875 in (101 mm x 250 mm)</i>		4 in x 9.875 in (10 sets) ELVMIDSPANBLOCK
Adjustable Beam Block <i>Actual dimensions: 5 in x 9.875 in (127 mm x 250 mm)</i>		5 in x 9.875 in (10 sets) ELVBEAMBLOCK
Deck Support Post <i>Actual dimensions: 3.5 in x 3.5 in x 10 ft (88 mm x 88 mm x 304 cm) 5.5 in x 5.5 in x 10 ft (139 mm x 139 mm x 304 cm)</i>		3.5 in x 3.5 in x 10 ft—Deck Support Post 5.5 in x 5.5 in x 10 ft—Deck Support Post www.trexdeckpost.com
Trex Elevations Universal Connector Clip (glass-filled nylon with stainless steel screw)		50 sq. ft (4.6 sq. m) box 500 sq. ft (46.5 sq. m) bucket ELVUNIVCLIP ELVUNIVCLIPPAIL
Trex Elevations Start Clip (stainless steel with stainless steel screw)		400 sq. ft (37.2 sq. m) bag ELVSTARTCLIP
Trex Elevations-Approved Spray Paint Net weight 12 oz.		Available in <b>Elevations grey</b> only. 1-800-966-7580

RAILING COMPONENTS (for use with Trex Elevations)

Joist Mount Post with Cap & Skirt <i>Actual dimensions: 2.5 in x 2.5 in x 63 in (63 mm x 63 mm x 160 cm)</i>		2.5 in x 2.5 in x 63 in XXJMNTPOST63
Trex Elevations Rail Post Blocking		10/box ELVRAILPOSTBLOCK
Trex Elevations Fascia Mount Kit (for use with Elevations steel framing)		For use with Joist Mount Trex Signature® Railing Post only. XXFMNTELEV

XX = COLOR PREFIX:    BK Charcoal Black    BZ Bronze    WT Classic White

Powder-coated products have a textured finish.







47

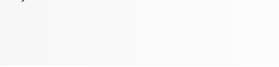

Trex Decking & Fascia

PROFILE	DESCRIPTION		ITEM NUMBER	COLORS	
1" Square-Edge Board		1 x 6 x 12'	Transcend Tropicals	XX010612TS01	IM, TT, HG, SR, LR
		1 x 6 x 16'	Transcend Tropicals	XX010616TS01	
		1 x 6 x 20'	Transcend Tropicals	XX010620TS01	
		1 x 6 x 12'	Transcend Earth Tones	XX010612T2S01	GP, RS, TH, VL, FP
		1 x 6 x 16'	Transcend Earth Tones	XX010616T2S01	
		1 x 6 x 20'	Transcend Earth Tones	XX010620T2S01	
		1 x 6 x 12'	Enhance Basics	XX010612E2S01	CS, BD, SD
		1 x 6 x 16'	Enhance Basics	XX010616E2S01	
		1 x 6 x 20'	Enhance Basics	XX010620E2S01	
		1 x 6 x 12'	Enhance Naturals	XX010612E2S01	FW, RH, TS, CB, SC
		1 x 6 x 16'	Enhance Naturals	XX010616E2S01	
		1 x 6 x 20'	Enhance Naturals	XX010620E2S01	
		7/8 x 6 x 12'	Select	XX010612SS01	PG, WG, SD, WB, MB
		7/8 x 6 x 16'	Select	XX010616SS01	
		7/8 x 6 x 20'	Select	XX010620SS01	

1" Grooved-Edge Board		1 x 6 x 12'	Transcend Tropicals	XX010612TG01	IM, TT, HG, SR, LR
		1 x 6 x 16'	Transcend Tropicals		
		1 x 6 x 20'	Transcend Tropicals		
		1 x 6 x 12'	Transcend Earth Tones	XX010612T2G01	GP, RS, TH, VL, FP
		1 x 6 x 16'	Transcend Earth Tones		
		1 x 6 x 20'	Transcend Earth Tones		
		1 x 6 x 12'	Enhance Basics	XX010612E2G01	CS, BD, SD
		1 x 6 x 16'	Enhance Basics		
		1 x 6 x 20'	Enhance Basics		
		1 x 6 x 12'	Enhance Naturals	XX010612E2G01	FW, RH, TS, CB, SC
		1 x 6 x 16'	Enhance Naturals		
		1 x 6 x 20'	Enhance Naturals		
		7/8 x 6 x 12'	Select	XX010612SG01	PG, WG, SD, WB, MB
		7/8 x 6 x 16'	Select		
		7/8 x 6 x 20'	Select		

1" x 8" Fascia		1 x 8 x 12'	Transcend Tropicals	XX010812TS01	IM, TT, HG, SR, LR
		1 x 8 x 12'	Transcend Earth Tones		
		1 x 8 x 12'	Transcend Earth Tones		
		1 x 8 x 12'	Enhance Basics	XX010812E2S01	CS, BD, SD
		1 x 8 x 12'	Enhance Naturals		
		1 x 8 x 12'	Enhance Naturals		
		1 x 8 x 12'	Select	XX010812SS01	PG, WG, SD, WB, MB
		1 x 8 x 12'	Universal White		
		1 x 8 x 12'	Universal White		
		1 x 8 x 12'	Transcend Tropicals	XX010812TS01	IM, TT, HG, SR, LR
		1 x 8 x 12'	Transcend Earth Tones		
		1 x 8 x 12'	Transcend Earth Tones		
1" x 12" Fascia		1 x 12 x 12'	Transcend Tropicals	XX011212TS01	IM, TT, HG, SR, LR
		1 x 12 x 12'	Transcend Earth Tones		
		1 x 12 x 12'	Transcend Earth Tones		
		1 x 12 x 12'	Enhance Basics	XX011212E2S01	CS, BD, SD
		1 x 12 x 12'	Enhance Naturals		
		1 x 12 x 12'	Enhance Naturals		
		1 x 12 x 12'	Select	XX011212SS01	PG, WG, SD, WB, MB
		1 x 12 x 12'	Universal White		
		1 x 12 x 12'	Universal White		
		1 x 12 x 12'	Transcend Tropicals	XX011212TS01	IM, TT, HG, SR, LR
		1 x 12 x 12'	Transcend Earth Tones		
		1 x 12 x 12'	Transcend Earth Tones		
2" Square-Edge Board		2 x 4 x 16'	Transcend Tropicals	XX020416TS01	IM, TT, HG, SR, LR
		2 x 6 x 12'	Transcend Tropicals		
		2 x 6 x 16'	Transcend Tropicals		
		2 x 6 x 20'	Transcend Tropicals	XX020612TS01	IM, TT, HG, SR, LR
		2 x 6 x 12'	Transcend Tropicals		
		2 x 6 x 16'	Transcend Tropicals		
		2 x 6 x 20'	Select	XX020612SS01	PG, SD, WB, MB
		2 x 6 x 12'	Select		
		2 x 6 x 16'	Select		
		2 x 6 x 20'	Select	XX020620SS01	PG, SD, WB, MB
		2 x 6 x 12'	Select		
		2 x 6 x 16'	Select		

XX = COLOR PREFIX:	IM	Island Mist	LR	Lava Rock	VL	Vintage Lantern	SD	Saddle	RH	Rocky Harbor	CS	Clam Shell
	TT	Tiki Torch	GP	Gravel Path	FP	Fire Pit	WB	Woodland Brown	TS	Toasted Sand	BD	Beach Dune
	HG	Havana Gold	RS	Rope Swing	PG	Pebble Grey	MB	Madeira	CB	Coastal Bluff	SD	Saddle
	SR	Spiced Rum	TH	Tree House	WG	Winchester Grey	FW	Foggy Wharf	SC	Sunset Cove		

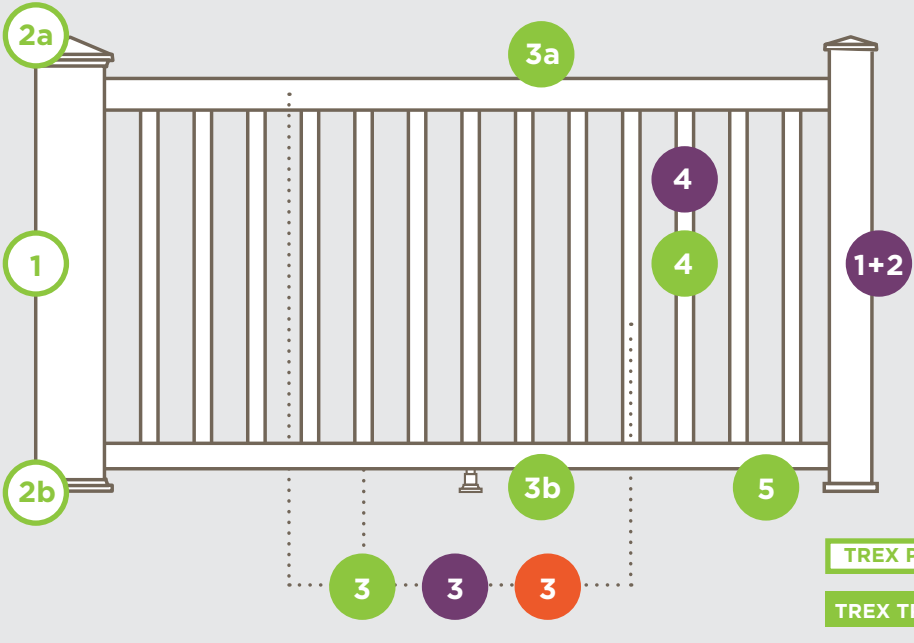

RAILING—  
a lot easier than it looks

Selecting the right railing is pretty easy, but each Trex® railing line is a little different. Please read the system descriptions at the top of each product section so you can choose exactly which railing components you need to complete your design. For additional guidance, the chart to the left depicts each railing system's components.

TREX POST COMPONENTS



TREX SIGNATURE® RAILING

TREX TRANSCEND® RAILING

TREX SELECT® RAILING

Trex Post Sleeves, Caps & Skirts

These components can be used as steps 1 & 2 for all Trex railing lines.

STEP	COMPONENT	DESCRIPTION	ITEM NUMBER
1		4" x 4" x 39" Post Sleeve <i>[4.45 in x 4.45 in x 40 in (113 mm x 113 mm x 101 cm) external dimensions]</i>	XX040439APS
		4" x 4" x 108" Post Sleeve <i>[4.45 in x 4.45 in x 108 in (113 mm x 113 mm x 274 cm) external dimensions]</i>	XX0404108APS
		6" x 6" x 39" Post Sleeve <i>[5.5 in x 5.5 in x 39 in (139 mm x 139 mm x 990 mm) external dimensions]</i>	WT060639APS
		6" x 6" x 108" Post Sleeve <i>[5.5 in x 5.5 in x 108 in (139 mm x 139 mm x 274 cm) external dimensions]</i>	WT0606108APS
2a		Flat 4" x 4" Post Sleeve Cap Pyramid 4" x 4" Post Sleeve Cap <i>[4.55 in x 4.55 in (115 mm x 115 mm) internal dimensions]</i>	PXXSQCAP4X4 PXXPYCAP4X4
		Flat 6" x 6" Post Sleeve Cap Pyramid 6" x 6" Post Sleeve Cap <i>[5.55 in x 5.55 in (140 mm x 140 mm) internal dimensions]</i>	PWTSQCAP6X6 PWTPYCAP6X6
Also available with LED lighting. See page 55.			
2b		4" x 4" Post Sleeve Skirt <i>[4.55 in x 4.55 in (115 mm x 115 mm) internal dimensions]</i>	PXXSKIRT4X4
		6" x 6" Post Sleeve Skirt <i>[5.55 in x 5.55 in (140 mm x 140 mm) internal dimensions]</i>	PWTSKIRT6X6
ACCESSORY	Surface Mount Post (for use with 4x4 composite post sleeve)	Aluminum Surface Mount Post for 36" (914 mm) Rail Height (1/box) <i>Actual external dimensions of insert: 3.75 in x 3.75 in x 7 in (95 mm x 95 mm x 177 mm)</i> Aluminum Surface Mount Post for 42" (1066 mm) Rail Height (1/box) <i>Actual external dimensions of insert: 3.75 in x 3.75 in x 7 in (95 mm x 95 mm x 177 mm)</i> Surface Mount Post Hardware—Wood (10 kits/box)	ALPOSTMOUNT36 ALPOSTMOUNT42 ALPOSTHWDECK
ACCESSORY	Joist Mount Post (for use with 4x4 composite post sleeve)	Aluminum Joist Mount Post for use with all Trex railing heights (1/box) <i>Actual external dimensions of insert: 3.75 in x 3.75 in x 7 in (95 mm x 95 mm x 177 mm)</i>	CPJMNTPOST63
ACCESSORY	Foot Block	Adjustable Foot Blocks	XXFTBLKPC

XX = COLOR PREFIX:	WT	Classic White	RS	Rope Swing	VL	Vintage Lantern	BK	Charcoal Black
	GP	Gravel Path	TH	Tree House	FP	Fire Pit		



Trex Signature® Railing

Choose either aluminum posts or composite post sleeves, caps and skirts for steps 1 & 2.  
Pair with a rail & baluster kit (step 3) and infill panel (step 4) if needed.

STEP	DESCRIPTION	ITEM NUMBER	DESCRIPTION	ITEM NUMBER
1+2	Aluminum Posts <small>(can only be used within the Trex Signature line)</small>			
	Trex Signature aluminum posts fulfill steps 1 & 2. If using composite post sleeves, refer to page 49.			
	2.5" x 2.5" x 37" Aluminum Post—Horizontal	XXAL252537RCAP	IRC Aluminum Mounting Plate & Hardware	ALPOSTHWDECK
	2.5" x 2.5" x 43" Aluminum Post—Horizontal	XXAL252543RCAP	For use with all Trex 2.5" Surface Mount Aluminum Posts	
	2.5" x 2.5" x 53" Aluminum Post—Stair	XXAL252553RCAP	Concrete Post Mount Kit	ALPOSTHWCONC
	Comes with cap and skirt.			
	2.5" x 2.5" x 36" Crossover Post—Horizontal	XXAL252536RCCP	2.5" x 2.5" x 63" Aluminum Joist Mount Post	XXJMNTPOST63
	2.5" x 2.5" x 42" Crossover Post—Horizontal	XXAL252542RCCP	Comes with cap and skirt.	
	Comes with skirt.		Trex Signature Fascia Mount Kit - wood framing	XXFMNTWOOD
			For use with Joist Mount Trex Signature Railing Post only.	
	2.5" x 2.5" x 37" Line Post with Premounted Brackets	BKAL252537RCAPLINE	Dimensions above are nominals. See below for actuals and metrics.	
	2.5" x 2.5" x 37" End Post with Premounted Brackets	BKAL252537RCAPEND	[2.5 in x 2.5 in x 36 in (63 mm x 63 mm x 914 mm) actual dimensions]	
	2.5" x 2.5" x 37" Corner Post with Premounted Brackets	BKAL252537RCAPCNR	[2.5 in x 2.5 in x 37 in (63 mm x 63 mm x 939 mm) actual dimensions]	
	2.5" x 2.5" x 43" Line Post with Premounted Brackets	BKAL252543RCAPLINE	[2.5 in x 2.5 in x 42 in (63 mm x 63 mm x 106 cm) actual dimensions]	
	2.5" x 2.5" x 43" End Post with Premounted Brackets	BKAL252543RCAPEND	[2.5 in x 2.5 in x 43 in (63 mm x 63 mm x 109 cm) actual dimensions]	
2.5" x 2.5" x 43" Corner Post with Premounted Brackets	BKAL252543RCAPCNR	[2.5 in x 2.5 in x 53 in (63 mm x 63 mm x 134 cm) actual dimensions]		
Comes with cap and skirt.		[2.5 in x 2.5 in x 63 in (63 mm x 63 mm x 160 cm) actual dimensions]		

STEP	DESCRIPTION	ITEM NUMBER	DESCRIPTION	ITEM NUMBER
3	<b>Rail &amp; Baluster Kit</b> <small>(includes Top Rail, Bottom Rail, Balusters, Mounting &amp; Support Hardware)</small>			
	6' x 36" Rail Kit w. Square Balusters—Horizontal	XXASO636HRK	6' x 42" Rail Kit w. Square Balusters—Horizontal	XXASO642HRK
	6' x 36" Rail Kit w. Square Balusters—Stair	XXASO636SRK	6' x 42" Rail Kit w. Square Balusters—Stair	XXASO642SRK
	8' x 36" Rail Kit w. Square Balusters—Horizontal	XXASO836HRK	8' x 42" Rail Kit w. Square Balusters—Horizontal	XXASO842HRK
	8' x 36" Rail Kit w. Square Balusters—Stair	XXASO836SRK	8' x 42" Rail Kit w. Square Balusters—Stair	XXASO842SRK
	6' x 36" Rail Kit w. Round Balusters—Horizontal	XXARO636HRK	6' x 42" Rail Kit w. Round Balusters—Horizontal	XXARO642HRK
	6' x 36" Rail Kit w. Round Balusters—Stair	XXARO636SRK	6' x 42" Rail Kit w. Round Balusters—Stair	XXARO642SRK
	8' x 36" Rail Kit w. Round Balusters—Horizontal	XXARO836HRK	8' x 42" Rail Kit w. Round Balusters—Horizontal	XXARO842HRK
	8' x 36" Rail Kit w. Round Balusters—Stair	XXARO836SRK	8' x 42" Rail Kit w. Round Balusters—Stair	XXARO842SRK
	4' x 36" Assembled Panel (Square)—Horizontal*	BKASO436HRPNL	<b>Dimensions above are nominals. See below for actuals and metrics.</b> <i>[4' x 36": 48 in x 36 in (122 cm x 914 mm) actual dimensions]</i> <i>[6' x 36": 72 in x 36 in (182 cm x 914 mm) actual dimensions]</i> <i>[8' x 36": 96 in x 36 in (243 cm x 914 mm) actual dimensions]</i> <i>[4' x 42": 48 in x 42 in (122 cm x 106cm) actual dimensions]</i> <i>[6' x 42": 72 in x 42 in (182 cm x 106 cm) actual dimensions]</i> <i>[8' x 42": 96 in x 42 in (243 cm x 106 cm) actual dimensions]</i>	

<b>Rail &amp; Rod Kit</b> <small>(includes Top Rail, Bottom Rail, Rods, Mounting &amp; Support Hardware)</small>				
6' x 36" Black Frame & Platinum Rod Railing—Horizontal	BKPLROD0636HRK	6' x 42" Black Frame & Black Rod Railing—Horizontal	BKBKROD0642HRK	
6' x 36" Black Frame & Platinum Rod Railing—Stair	BKPLROD0636SRK	6' x 42" Black Frame & Black Rod Railing—Stair	BKBKROD0642SRK	
8' x 36" Black Frame & Platinum Rod Railing—Horizontal	BKPLROD0836HRK	8' x 42" Black Frame & Black Rod Railing—Horizontal	BKBKROD0842HRK	
8' x 36" Black Frame & Platinum Rod Railing—Stair	BKPLROD0836SRK	8' x 42" Black Frame & Black Rod Railing—Stair	BKBKROD0842SRK	
6' x 36" Bronze Frame & Platinum Rod Railing—Horizontal	BZPLROD0636HRK	36" Rod Rail Vertical Kit—Horizontal	XX36RODHVERTK	
6' x 36" Bronze Frame & Platinum Rod Railing—Stair	BZPLROD0636SRK	36" Rod Rail Vertical Kit—Stair	XX36RODSVERTK	
8' x 36" Bronze Frame & Platinum Rod Railing—Horizontal	BZPLROD0836HRK	42" Rod Rail Vertical Kit—Horizontal	XX42RODHVERTK	
8' x 36" Bronze Frame & Platinum Rod Railing—Stair	BZPLROD0836SRK	42" Rod Rail Vertical Kit—Stair	XX42RODSVERTK	
6' x 36" Black Frame & Black Rod Railing—Horizontal	BKBKROD0636HRK	<b>Dimensions above are nominals. See below for actuals and metrics.</b> <i>[6' x 36": 72 in x 36 in (182 cm x 914 mm) actual dimensions]</i> <i>[8' x 36": 96 in x 36 in (243 cm x 914 mm) actual dimensions]</i> <i>[6' x 42": 72 in x 42 in (182 cm x 106 cm) actual dimensions]</i> <i>[8' x 42": 96 in x 42 in (243 cm x 106 cm) actual dimensions]</i>		
6' x 36" Black Frame & Black Rod Railing—Stair	BKBKROD0636SRK			
8' x 36" Black Frame & Black Rod Railing—Horizontal	BKBKROD0836HRK			
8' x 36" Black Frame & Black Rod Railing—Stair	BKBKROD0836SRK			
6' x 42" Black Frame & Platinum Rod Railing—Horizontal	BKPLROD0642HRK			
6' x 42" Black Frame & Platinum Rod Railing—Stair	BKPLROD0642SRK			
8' x 42" Black Frame & Platinum Rod Railing—Horizontal	BKPLROD0842HRK			

Trex Signature® Railing

Choose either aluminum posts or composite post sleeves, caps and skirts for steps 1 & 2.  
Pair with a rail & baluster kit (step 3) and infill panel (step 4) if needed.

STEP	COMPONENT	DESCRIPTION	ITEM NUMBER
3	<b>Mesh Rail Kit</b> <small>(includes Top Rail, Bottom Rail, Footblock, Verticals, Anti-Rattle Gaskets, Hardware and Bracket Pack)</small>		
			
	6' x 36" Mesh Railing Kit—Horizontal		XXA0636PNLHRK
	6' x 36" Mesh Railing Kit—Stair		XXA0636PNLSRK
	8' x 36" Mesh Railing Kit—Horizontal		XXA0836PNLHRK
	8' x 36" Mesh Railing Kit—Stair		XXA0836PNLSRK
	6' x 42" Mesh Railing Kit—Horizontal		XXA0642PNLHRK
	6' x 42" Mesh Railing Kit—Stair		XXA0642PNLSRK
	8' x 42" Mesh Railing Kit—Horizontal		XXA0842PNLHRK
	8' x 42" Mesh Railing Kit—Stair		XXA0842PNLSRK

## Glass Rail Kit

(includes Top Rail, Bottom Rail, Footblock, Verticals, Hardware and Bracket Pack)

6' Glass Railing Kit—Horizontal

XXA06HGLRK

Available in BK and WT only.  
Glass infill not included. Utilizes readily available 1/4" tempered glass.

Glass can be sourced by contacting your local glazier or call  
**1-800 BUY-TREX** for more information.

**Dimension above is nominal. See below for actual and metric.**  
[6': 72 in (182 cm) actual dimension]

4

## Mesh Panel

(includes Stainless Steel Mesh Panel) For use with Trex Signature Mesh Kit.

6' x 36" Stainless Steel Mesh Panel—Horizontal

SSMESH0636HZ

8' x 36" Stainless Steel Mesh Panel—Horizontal

SSMESH0836HZ

8' x 42" Stainless Steel Mesh Panel—Horizontal

SSMESH0842HZ

Universal 316 Stainless Steel Mesh Panel—Stair

SSMESHUNIVST

**Dimensions above are nominals. See below for actuals and metrics.**  
[6' x 36": 64 in x 32.375 in (162 cm x 822 mm) actual dimensions]  
[8' x 36": 88 in x 32.375 in (223 cm x 822 mm) actual dimensions]  
[8' x 42": 88 in x 38.375 in (223 cm x 974 mm) actual dimensions]  
[Universal 316: 108.1875 in x 36.1875 in (274 cm x 919 mm) actual dimensions]

STEP

DESCRIPTION

ITEM NUMBER

DESCRIPTION

ITEM NUMBER

ACCESSORY	DESCRIPTION	ITEM NUMBER	DESCRIPTION	ITEM NUMBER
<b>Trex Signature Accessories</b>				
				
Trex Signature Bracket Templates				
Bracket Template—Horizontal (36" and 42") - Composite Sleeve		SIGTEMP4X4SLEEVE	Cocktail Rail Bracket (10/pack)	XXCTBK TAL10PK
Bracket Template —Horizontal (36" and 42") - 2.5" Aluminum Post		SIGTEMPIRCPOST	Fixed Bracket—Horizontal (4/pack)	XXFHBKTAL
			Fixed Bracket—Stair (4/pack)	XXFSBK TAL
			Tabless Fixed Bracket—Horizontal (4/pack)	XXFHBKTALPNL
			Swivel Bracket—Horizontal (2/pack—1 top, 1 bottom)	XXSWHBTAL
			Swivel Bracket—Stair (2/pack—1 top, 1 bottom)	XXSWSBTAL
			2.5" Crossover Bracket—Horizontal (1/pack)	XX25FHCBKTAL
			2.5" Swivel Crossover Bracket—Stair (1/pack)	XX25RCSWSCBK TAL
			Compound Swivel Bracket (2/pack—1 top, 1 bottom)	XXCPDSWBKTAL
			Aluminum Foot Block	XXALFTBLK
			Touch-up Pen	XXTOUCHUPPEN



Trex Transcend® Railing



Transcend is either a 3-step or 5-step process. Choose Trex post sleeves, caps and skirts (steps 1 & 2), then choose a rail & baluster kit (step 3). OR choose each component individually for a custom design (steps 4 & 5).

3a

3b

Top & Bottom Rails

In this step, two rails (1 top, 1 bottom) must be selected.



Crown

Universal

6' Crown Top Rail

8' Crown Top Rail

6' Universal Top/Bottom Rail

8' Universal Top/Bottom Rail

[6' Rail: 67.5 in (171 cm) actual length; 8' Rail: 91.5 in (232 cm) actual length]



4

Balusters

See chart below for number of balusters needed to complete each railing section.

BALUSTER TYPE	PER 6' SECTION	PER 8' SECTION
Square (Horizontal application)	13	18
Square (Stair application)	11	15
Aluminum (Horizontal application)	15	20
Aluminum (Stair application)	12	16

Aluminum balusters are available in Charcoal Black, Classic White and Bronze only (BK, WT, BZ).



Square Balusters for 36" Rail Height (16/pack)

[1.418 in x 1.418 in x 30.375 in (36 mm x 36 mm x 771 mm) actual dimensions]

Square Balusters for 42" Rail Height (16/pack)

[1.418 in x 1.418 in x 36.375 in (36 mm x 36 mm x 923 mm) actual dimensions]

Round Aluminum Balusters for 36" Rail Height (20/pack)

[.75 in x 30.25 in (19 mm x 768 mm) actual dimensions]

Round Aluminum Balusters for 42" Rail Height (20/pack)

[.75 in x 36.25 in (19 mm x 920 mm) actual dimensions]

Square Aluminum Balusters for 36" Rail Height (20/pack)

[.75 in x 30.25 in (19 mm x 768 mm) actual dimensions]

Square Aluminum Balusters for 42" Rail Height (20/pack)

[.75 in x 36.25 in (19 mm x 920 mm) actual dimensions]

XXCROWNTR06

XXCROWNTR08

XXUNIVTBRO6

XXUNIVTBRO8

XXO20230SBK

XXO20236SBK

XXTA30RBK

XXTA36RBK

XXTA30SBK

XXTA36SBK

5	Accessory Infill Kit		
	» 2 Baluster Spacers		
	» Adjustable Foot Block		
	» Mounting Hardware		

ACCESSORY Trex Transcend Accessories

All accessories include a quantity of 12 per box unless otherwise noted.



Trex Transcend Bracket Template

Mounting Hardware for Cut Rails—Horizontal	XXHZACCYKIT
Mounting Hardware for Cut Rails—Stair	XXSTACCYKIT
Transcend RSB Bracket Pack—Horizontal (24/box)	TSHBRACKET
Transcend RSB Bracket Pack—Stair (24/box)	TSSBRACKET
0 Degree Rail Gasket Pack—Horizontal	XXO0HGASK
0 Degree Rail Gasket Pack—Stair	XXO0SGASK
22.5 Degree Gasket Pack	XX22HGASK
45 Degree Birdsmouth Gasket Pack (for 4x4)	XX45RSBADAPK
45 Degree Gasket Pack (for 6x6)	WT45HGASK
Bracket Template—Horizontal (36" and 42") - Composite Sleeve	TSCTEMP4X4SLEEVE



Trex Transcend® Railing

Or simply choose a rail & baluster kit (3-step).

STEP	COMPONENT	DESCRIPTION	ITEM NUMBER	COLOR
3	<div>Rail &amp; Baluster Kit – Composite</div> <div><div>» Crown Top Rail</div><div>» Universal Bottom Rail</div><div>» Square Balusters</div><div>» Baluster Spacers</div><div>» Adjustable Foot Block</div><div>» Mounting Hardware</div></div> <div></div> <div>[Actual dimensions: 6' Rail: 67.5 in x 36 in (171 cm x 914 mm); 8' Rail: 91.5 in x 36 in (232 cm x 914 mm)]</div>	6' x 36" Rail & Baluster Kit—Horizontal with square composite balusters	XXO636HRK	WT, BK, VL
		6' x 36" Rail & Baluster Kit—Stair with square composite balusters	WT0636SRK	WT
		8' x 36" Rail & Baluster Kit—Horizontal with square composite balusters	XXO836HRK	WT, BK, VL
		8' x 36" Rail & Baluster Kit—Stair with square composite balusters	XXO836SRK	WT, BK, VL
		6' x 42" Rail & Baluster Kit—Horizontal with square composite balusters	XXO642HRK	WT, BK, VL
		8' x 42" Rail & Baluster Kit—Horizontal with square composite balusters	XXO842HRK	WT, BK, VL
		8' x 42" Rail & Baluster Kit—Stair with square composite balusters	XXO842SRK	WT, BK, VL

Trex Select® Railing

Trex Select is a 3-step process. Choose Trex post sleeves, caps and skirts (steps 1 & 2) and a rail & baluster kit (step 3).

STEP	COMPONENT	DESCRIPTION	ITEM NUMBER
3	<div>Classic White Rail &amp; Aluminum Baluster Kit</div> <div><div><div>» Top Rail</div><div>» Bottom Rail</div><div>» Round Aluminum Balusters</div><div>» Adjustable Foot Block</div><div>» Hardware Pack</div></div><div>Available in Classic White with Charcoal Black Aluminum Balusters only.</div></div> <div></div>	6' x 36" Rail & Aluminum Baluster Kit—Horizontal 6' x 36" Rail & Aluminum Baluster Kit—Stair  8' x 36" Rail & Aluminum Baluster Kit—Horizontal 8' x 36" Rail & Aluminum Baluster Kit—Stair  6' x 42" Rail & Aluminum Baluster Kit—Horizontal 8' x 42" Rail & Aluminum Baluster Kit—Horizontal 8' x 42" Rail & Aluminum Baluster Kit—Stair  <i>[Actual dimensions: 6' Rail: 67.5 in x 36 in / 42 in (171 cm x 914 mm / 106 cm); 8' Rail: 91.5 in x 36 in / 42 in (232 cm x 914 mm / 106 cm)]</i>	WTRD0636HSELK WTRD0636SSELK  WTRD0836HSELK WTRD0836SSELK  WTRD0642HSELK WTRD0842HSELK WTRD0842SSELK
ACCESSORY	Trex Select Accessories	Mounting Hardware for Cut Rails—Horizontal (10 kits/box) Mounting Hardware for Cut Rails—Stair (10 kits/box)	BKENHZBKT BKENSTBKT
	Trex Select 8' Aluminum Rail Stiffener	<div></div>	SELALRAILSTIFFENER



Trex Aluminum Gates

Component	Description	Item Number
Gate Rail Kit	36" Rail Height, Square Balusters, Adjustable up to 48" wide opening 36" Rail Height, Round Balusters, Adjustable up to 48" wide opening 42" Rail Height, Square Balusters, Adjustable up to 48" wide opening 42" Rail Height, Round Balusters, Adjustable up to 48" wide opening <small>[Actual height 36" Rail: 36 in (914 mm); 42" Rail: 42 in (106 cm) Actual width is 47.5 in (120 cm) but can be cut to fit any width.]</small>	XX36SQADJGATE XX36RDADJGATE XX42SQADJGATE XX42RDADJGATE
Hardware Pack	 2 Adjustable Self-Closing Hinges 1 Locking Hasp With Keys Hardware for attachment to wood post with composite sleeve or aluminum posts	BKGATEHW



Trex Aluminum ADA Compliant Handrail

Component	Item Number
1.375 in x 8 ft (34 mm x 243 cm) Hand Rail	XXALADARAIL8
Wall Return 90°	XXALADA90WR2G
Wall Mount	XXALADAWMNT2G
Corner Mount	XXALADAICORNER2G
Post Return ("Candy Cane")	XXALADA18OCCANE
5° Elbow	XXALADA05ELB
31° Elbow	XXALADA31ELB
34° Elbow	XXALADA34ELB
36° Elbow	XXALADA36ELB
90° Inside/Outside Elbow	XXALADA90ELB2G
Straight 4 in (101 mm) Internal Connector	XXALINTCONN
Inline Rail Termination Adapter	XXALADAINLINE
Rail End Cap	XXALADACAP
Aluminum Collar	XXALADACL



All Trex ADA handrail components are made of powder-coated aluminum. For detailed installation instructions, visit [trex.com](https://www.trex.com)

Decking Accessories

Trex Hideaway® Hidden Fastening System	Description	Item Number
Universal Fastener (glass-filled nylon)	50 sq. ft (4.6 sq. m) box 500 sq. ft (46.5 sq. m) bucket	UNIVCONCLIP DA00002
Universal Starter Clip	400 sq. ft (37 sq. m) bag	UNIVSTARTCLIP
Router Bit	Router Bit	ROUTBIT



Trex® OutdoorLighting™

Lighting & Description	Item Number
Deck Lighting	
Pyramid or Flat Post Cap Light » 4" x 4" LED Post Cap Light <small>[4.55 in x 4.55 in (115 mm x 115 mm) actual internal dimensions]</small> <small>Use with Trex 4 in Composite Railing Posts</small> » 5.5 ft (1.67 m) Male LightHub® Lead Aluminum Post Cap Light » 2.5" x 2.5" LED Aluminum Post Cap Light <small>[2.6 in x 2.6 in (66 mm x 66 mm) actual internal dimensions]</small> <small>Use with Trex 2.5 in Aluminum Railing Posts</small> » 5.5 ft (1.67 m) Male LightHub Lead	 <b>PYRAMID CAPS</b> BKPYLEDCAP4X4C WTPYLEDCAP4X4C FPPYLEDCAP4X4C THPYLEDCAP4X4C VLPYLEDCAP4X4C GPPYLEDCAP4X4C RSPYLEDCAP4X4C <b>FLAT CAPS</b> BKSQLEDCAP4X4C WTSQLEDCAP4X4C FPSQLEDCAP4X4C THSQLEDCAP4X4C VLSQLEDCAP4X4C GPSQLEDCAP4X4C RSSQLEDCAP4X4C TEXTURED CHARCOAL BLACK: BKALCAPLED25 TEXTURED BRONZE: BZALCAPLED25 TEXTURED WHITE: WTALCAPLED25
Deck Rail Light » LED Deck Rail Light <small>[2.75 in (69 mm) OD]</small> » 5.5 ft (1.67 m) Male LightHub Lead Wedge Deck Rail Light » LED Wedge Deck Rail Light <small>[1.875 in wide x 3 in high (47 mm x 76 mm) actual dimensions]</small> <small>Compatible with all Trex Railing Posts</small> » 5.5 ft (1.67 m) Male LightHub Lead	 TEXTURED CHARCOAL BLACK: BKLAMPLED TEXTURED BRONZE: BZLAMPLED TEXTURED CLASSIC WHITE: WTLAMPLED  TEXTURED CHARCOAL BLACK: BKALPOSTLAMPLED TEXTURED BRONZE: BZALPOSTLAMPLED TEXTURED CLASSIC WHITE: WTALPOSTLAMPLED
LED Riser Lights » 4 LED Riser Lights <small>[1.25 in (31 mm) OD]</small> » 5.5 ft (1.67 m) Male LightHub Lead	 TEXTURED CHARCOAL BLACK: BKRISERLED4PKC TEXTURED BRONZE: BZRISERLED4PKC TEXTURED CLASSIC WHITE: WTRISERLED4PKC
Recessed Deck Lights » 4 LED Recessed Lights <small>[1 in (25 mm) OD]</small> » 5.5 ft (1.67 m) Male LightHub Lead	 RECESSLED4PKC
Accessories	
Transformer with Timer » Output Voltage: 12VDC » Output Power: 100W or 30W » Output Current: 8.3A or 2.5A » Photo-Activated Timer » 20 ft (6.09 m) LightHub Wire Extension Cable Multi-zone Transformer Adapter	 8.3A, 100W: DIMMABLE 83DLTRANSFORMERCC 2.5A, 30W: 25DLTRANSFORMER  DL5TFSPPLIT1PK
Motion Controller and Dimmer » 1 Remote » 1 Motion Sensor » 2 AAA Batteries » 2 Screws » 5 ft. Male/Male Wire Extension Cable	 BKDLMOTION WTDLMOTION
Dimmer » Single Channel with Remote	 DLDIMMER
1 in (25 mm) Forstner Bit—Pack of 6	 DLBIT6PK
LightHub Accessories » 3-Way Splitter » 6-Way Splitter » 5 ft (1.52 m) Wire Extension Cable » 10 ft (3.04 m) Wire Extension Cable » 20 ft (6.09 m) Wire Extension Cable » 40 ft (12.19 m) Wire Extension Cable » 60 ft (18.28 m) Wire Extension Cable » Female to Female Adapter	 DL3SPLIT6PK DL6SPLIT4PK DL5FTWR4PK DL10FTWR4PK DL20FTWR4PK DL40FTWR2PK DL60FTWR1PK DLFADAP6PK





## TREX® LIMITED WARRANTY

Trex Company, Inc. (hereinafter “Trex”) warrants to the original purchaser (“Purchaser”) that, for the period of time set forth in the following sentence, under normal use and service conditions, Trex® product (the “Product”) shall be free from material defects in workmanship and materials, and shall not split, splinter, rot or suffer structural damage from termites or fungal decay. The term of such warranty shall be twenty-five (25) years from the date of original purchase for a residential application, and ten (10) years from the date of original purchase for a commercial application. If a defect occurs within the warranty period, Purchaser shall notify Trex in writing and, upon confirmation by an authorized Trex representative of the defect, Trex’s sole responsibility shall be, at its option, to either replace the defective Product or refund the portion of the purchase price paid by Purchaser for such defective Product (not including the cost of its initial installation).

For purposes of this warranty, a “residential application” shall refer to an installation of the Product on an individual residence, and a “commercial application” shall refer to any installation of the Product other than on an individual residence.

**Notwithstanding the foregoing, (a), the term of the warranty for the LED lights and housing for Trex DeckLighting™ shall be seven (7) years, the term of the warranty for the LED lights and housing for Trex LandscapeLighting™ shall be five (5) years, the term of the warranty for the dimmer, timer and transformer for both shall be three (3) years, and the term of the warranty for the motion controller for both shall be one (1) year, in each case provided that a Trex transformer is used (with no warranty on any components if a Trex transformer is not used), and any other parts or accessories shall not be warranted; (b) with respect to hardware for the Trex Surroundings® gate (gate frame, hinges and screws), the term of the warranty shall be five (5) years, (c) with respect to Trex Decorative Balusters, the term of the warranty covering the paint coating shall be ten (10) years, and shall be prorated in the following manner: 100% replacement for the first five (5) years; and 50% replacement for the next five (5) years, (d) the term of the warranty for Transcend Product used as outdoor cladding shall be twenty-five (25) years for both a residential application and a commercial application, and (e) this warranty shall not apply to Trex Elevations® steel deck framing, Trex Signature® aluminum railing and TrexTrim™ (which each have separate warranties).**

**TO THE FULLEST EXTENT PERMITTED UNDER THE LAW, THIS WARRANTY SHALL NOT COVER AND TREX SHALL NOT BE RESPONSIBLE FOR COSTS AND EXPENSES INCURRED WITH RESPECT TO THE REMOVAL OF DEFECTIVE PRODUCT OR THE INSTALLATION OF REPLACEMENT MATERIALS, INCLUDING BUT NOT LIMITED TO LABOR AND FREIGHT.**

With respect to a residential application, this warranty may be transferred one (1) time, within the five (5) year period beginning from the date of original purchase by the Purchaser, to a subsequent buyer of the

property upon which the Product was originally installed. With respect to a commercial application, this warranty is freely transferable to subsequent buyers of the property upon which the Product was originally installed.

To make a claim under this limited warranty, Purchaser, or the transferee, shall send to Trex, within the warranty period referred to above, a description of the claimed defect and proof of purchase, to the following address:

Trex Company, Inc.  
Customer Relations  
160 Exeter Drive  
Winchester, VA 22603-8605

Trex does not warrant against and is not responsible for any condition attributable to: (1) improper installation of Product and/or failure to abide by Trex’s installation guidelines, including but not limited to improper gapping; (2) use of Product beyond normal use and service conditions, or in an application not recommended by Trex’s guidelines and local building codes; (3) movement, distortion, collapse or settling of the ground or the supporting structure on which Product is installed; (4) any act of God (such as flooding, hurricane, earthquake, lightning, etc.), environmental condition (such as air pollution, mold, mildew, etc.), staining from foreign substances (such as dirt, grease, oil, etc.), or normal weathering (defined as exposure to sunlight, weather and atmosphere which will cause any colored surface to gradually fade, chalk, or accumulate dirt or stains); (5) variations or changes in color of Product; (6) improper handling, storage, abuse or neglect of Product by Purchaser, the transferee or third parties; or (7) ordinary wear and tear.

No person or entity is authorized by Trex to make and Trex shall not be bound by any statement or representation as to the quality or performance of Product other than as contained in this warranty. This warranty may not be altered or amended except in a written instrument signed by Trex and Purchaser.

**TO THE FULLEST EXTENT PERMITTED UNDER THE LAW, UNDER NO CIRCUMSTANCES WILL TREX BE LIABLE FOR INCIDENTAL OR CONSEQUENTIAL DAMAGES, WHETHER SUCH DAMAGES ARE SOUGHT IN CONTRACT, IN TORT (INCLUDING BUT NOT LIMITED TO NEGLIGENCE AND STRICT LIABILITY) OR OTHERWISE, AND TREX’S LIABILITY FOR NON-PERSONAL INJURY CLAIMS WITH RESPECT TO DEFECTIVE PRODUCT SHALL IN NO EVENT EXCEED THE REPLACEMENT OF SUCH PRODUCT OR REFUND OF THE PURCHASE PRICE, AS DESCRIBED ABOVE.**

Some States or Provinces do not allow the exclusion or limitation of incidental or consequential damages, so the above limitation or exclusion may not apply to you. This warranty gives you specific legal rights, and you may also have other rights that vary from State to State or Province to Province.

Copyright © 2019 Trex Company, Inc.



## TREX TRANSCEND®, TREX ENHANCE®, TREX SELECT® AND TREX® UNIVERSAL FASCIA LIMITED FADE & STAIN WARRANTY

For the term set forth below, Trex Company, Inc. (hereinafter “Trex”) warrants to the original end-user purchaser (the “Purchaser”) that Trex Transcend® decking, porch or fascia, Trex Enhance® decking or fascia, Trex Select® decking or fascia or Trex Universal Fascia, as the case may be (the “Product”) will perform, under normal use and service conditions, as follows:

**Term of Warranty:** The term of this warranty shall begin on the date of original purchase, and shall end (1) twenty-five (25) years thereafter for a residential application of the Product, and (2) ten (10) years thereafter for a commercial application of the Product. Notwithstanding the foregoing, the term of this warranty for Transcend Product used as outdoor cladding shall be twenty-five (25) years for both a residential application and a commercial application.

**Residential/Commercial Application:** For purposes of this warranty, a “residential application” shall refer to an installation of the Product on an individual residence, and a “commercial application” shall refer to any installation of the Product other than on an individual residence.

**Fade Resistance:** The Product shall not fade in color from light and weathering exposure as measured by color change of more than 5 Delta E (CIE) units.

The Product is designed to resist fading. No material is fade proof when exposed to years of UV exposure and the elements. The Product is designed to resist fading, and will not in any event fade by more than 5 Delta E (CIE) units.

**Stain Resistance:** The Product shall be resistant to permanent staining resulting from spills of food and beverage items including ketchup, mustard, salad oils, tea, wine, coffee, fruit punch, barbeque sauce, grease, sodas and other food and beverage related items that would typically be present on a residential deck, or mold and mildew naturally occurring in the environment, provided that such substances are removed from the Product with soap and water or mild household cleaners within one (1) week of exposure of the food or beverage to the surface or first appearance of the mold and mildew.

Notwithstanding the foregoing, Trex does not warrant that the Product is stain-proof, and does not warrant stain resistance resulting from spilled or otherwise applied food and beverage substances which are not properly cleaned as provided above within one (1) week of exposure. In addition, materials not covered in the stain resistant warranty include abrasive compounds of acidic or basic pH, paints or stains, strong solvents, metallic rust or other abnormal deck use items, and non-food and non-beverage substances, including but not limited to, biocides, fungicides, plant food, or bactericides. Mold and mildew can settle and grow on any outdoor surface, including this Product. You should periodically clean your deck to remove dirt and pollen that can feed mold and mildew. This warranty does not cover mold and mildew which is not properly cleaned as provided above within one (1) week of first appearance.

**Standard Trex Company Limited Warranty:** This warranty is in addition to the standard Trex Company Limited Warranty that applies to all Trex products.

**Transferability:** With respect to a residential application, this warranty may be transferred one (1) time, within the five (5) year period beginning from the date of original purchase by the Purchaser, to a subsequent buyer of the property upon which the Trex products were originally installed. With respect to a commercial application, this warranty is freely transferable to subsequent buyers of the property upon which the Trex products were originally installed.

### EXCLUSIONS FROM WARRANTY COVERAGE:

**Exposure to Heat:** Direct or indirect contact with extreme heat sources (over 275 degrees) may cause fading and may damage the surface of the Product, and any effects of such exposure are expressly excluded from coverage under this warranty.

**Surface Damage:** Never use metal shovels or sharp-edged tools to remove snow and ice on the surface of the Product. If the surface of the Product is damaged or punctured, this warranty will be voided.

**Paint or Other Materials Applied to the Product:** If paint or other coating materials are applied to the Product, this warranty will be voided.

**Railing:** This warranty does not cover Trex Transcend®, Trex Enhance® or Trex Select® railing components.

**Other Exclusions:** This warranty shall not cover any condition attributable to: (1) improper installation of the Product and/or failure to abide by Trex’s installation guidelines, including but not limited to improper gapping; (2) use of the Product beyond normal use or service conditions, or in an application not recommended by Trex’s guidelines and local building codes; (3) movement, distortion, collapse or settling of the ground or the supporting structure on which the Product is installed; (4) any act of God (such as flooding, hurricane, earthquake, lightning, etc.); (5) improper handling, storage, abuse or neglect of the Product by Purchaser, the transferee or third parties; (6) any fading or staining not on the walking surface of the Product (i.e., the underside or the ends of the Product); or (7) ordinary wear and tear.

### Procedure for Making a Claim under this Warranty

In order to make a claim under this warranty, Purchaser must do the following:

1. If the Purchaser is making a claim relating to the warranty on stain resistance, Purchaser must do as follows:

(a) Purchaser must try to clean the affected area of the deck by using the cleaning procedures described above within one (1) week of exposure of the food or beverage to the Product or first appearance of the mold and mildew.

(b) If the affected area remains reasonably unsatisfactory after Purchaser has tried these cleaning procedures, then Purchaser must have the affected area of the deck professionally cleaned at Purchaser’s expense.

(c) If the affected area remains reasonably unsatisfactory after the professional cleaning, Purchaser may make a claim under this warranty, provided that such claim is made within thirty (30) days after the professional cleaning.

2. To make a claim under this limited warranty, Purchaser, or the transferee, shall send to Trex, within the warranty period referred to above, a description and photographs of the affected area of the Product, proof of purchase, and if the claim relates to the warranty on stain resistance, proof of compliance with paragraph 1. above, to the following address:

Trex Company, Inc.  
Customer Relations  
160 Exeter Drive  
Winchester, VA 22603-8605

3. Upon confirmation by an authorized Trex representative of a valid claim hereunder, Trex’s sole responsibility shall be, at its option, to either replace the affected item or refund the portion of the purchase price paid by Purchaser for such affected item (not including the cost of its initial installation).

Replacement material will be provided that is as close as possible in color, design and quality as the replaced material, but Trex does not guarantee an exact match as colors and design may change.

4. If a valid warranty claim hereunder is made during years eleven (11) through twenty-five (25) after the original purchase for a residential application, recovery will be prorated. If Trex is providing replacement materials, it may elect to replace the percentage listed below of boards otherwise meeting the requirements for a claim, or if it is refunding the purchase price, it may elect to refund the percentage listed below of the purchase price of boards otherwise meeting the requirements for a claim.

YEAR OF WARRANTY CLAIM	PERCENTAGE RECOVERY
11	80%
12	80%
13	80%
14	60%
15	60%
16	60%
17	40%
18	40%
19	40%
20	20%
21	20%
22	20%
23	10%
24	10%
25	10%

**5. TO THE FULLEST EXTENT PERMITTED UNDER THE LAW, THIS WARRANTY SHALL NOT COVER AND TREX SHALL NOT BE RESPONSIBLE FOR COSTS AND EXPENSES INCURRED WITH RESPECT TO THE REMOVAL OF AFFECTED PRODUCT OR THE INSTALLATION OF REPLACEMENT MATERIALS, INCLUDING BUT NOT LIMITED TO LABOR AND FREIGHT.**

No person or entity is authorized by Trex to make and Trex shall not be bound by any statement or representation as to the quality or performance of Trex products other than as contained in this warranty. This warranty may not be altered or amended except in a written instrument signed by Trex and Purchaser.

**TO THE FULLEST EXTENT PERMITTED UNDER THE LAW, UNDER NO CIRCUMSTANCES WILL TREX BE LIABLE FOR INCIDENTAL OR CONSEQUENTIAL DAMAGES, WHETHER SUCH DAMAGES ARE SOUGHT IN CONTRACT, IN TORT (INCLUDING BUT NOT LIMITED TO NEGLIGENCE AND STRICT LIABILITY) OR OTHERWISE, AND TREX’S LIABILITY FOR NON-PERSONAL INJURY CLAIMS WITH RESPECT TO PRODUCTS SHALL IN NO EVENT EXCEED THE REPLACEMENT OF SUCH PRODUCTS OR REFUND OF THE PURCHASE PRICE, AS DESCRIBED ABOVE.**

Some States or Provinces do not allow the exclusion or limitation of incidental or consequential damages, so the above limitation or exclusion may not apply to you. This warranty gives you specific legal rights, and you may also have other rights that vary from State to State or Province to Province.

Copyright © 2019 Trex Company, Inc.





## TREX SIGNATURE®/REVEAL® RAILING LIMITED WARRANTY

Trex Company, Inc. (hereinafter “Trex”) warrants to the original purchaser (“Purchaser”) that, under normal use and service conditions, Trex Signature/Reveal® Railing (the “Product”) shall, for a period of twenty-five (25) years from the date of original purchase, be free from material defects in workmanship and materials. If a defect occurs within the warranty period, Purchaser shall notify Trex in writing and, upon confirmation by an authorized Trex representative of the defect, Trex’s sole responsibility shall be, at its option, to either replace the defective Product or refund the portion of the purchase price paid by Purchaser for such defective Product (not including the cost of its initial installation).

With respect to installations where the atmosphere is influenced by a body of salt water (or other contaminant conditions), failure to adhere to the cleaning guidelines available at [www.trex.com](http://www.trex.com) will void this warranty with respect to any condition resulting from such failure.

**TO THE FULLEST EXTENT PERMITTED UNDER THE LAW, THIS WARRANTY SHALL NOT COVER AND TREX SHALL NOT BE RESPONSIBLE FOR COSTS AND EXPENSES INCURRED WITH RESPECT TO THE REMOVAL OF DEFECTIVE PRODUCT OR THE INSTALLATION OF REPLACEMENT MATERIALS, INCLUDING BUT NOT LIMITED TO LABOR AND FREIGHT.**

This warranty may be transferred one (1) time, within the five (5) year period beginning from the date of original purchase by the Purchaser, to a subsequent buyer of the property upon which the Product was originally installed.

To make a claim under this limited warranty, Purchaser, or the transferee, shall send to Trex, within the warranty period referred to above, a description of the claimed defect and proof of purchase, to the following address:

Trex Company, Inc.  
Customer Relations  
160 Exeter Drive  
Winchester, VA 22603-8605

Trex does not warrant against and is not responsible for any condition attributable to: (1) improper installation of the Product; (2) use of the Product beyond normal use and service conditions, or in an application not recommended by Trex’s guidelines and local building codes; (3) movement, distortion, collapse or settling of the ground or the supporting structure on which the Product is installed; (4) damages attributable to fire, violent storms, earthquake or other Acts of God, accidents, vandalism, or other casualties, impact of objects, or exposure to atmospheric pollutants or conditions other than natural weather processes, (5) improper handling, storage, abuse or neglect of the Product by Purchaser, the transferee or third parties; or (6) ordinary wear and tear.

No person or entity is authorized by Trex to make and Trex shall not be bound by any statement or representation as to the quality or performance of Trex products other than as contained in this warranty. This warranty may not be altered or amended except in a written instrument signed by Trex and Purchaser.

**TO THE FULLEST EXTENT PERMITTED UNDER THE LAW, UNDER NO CIRCUMSTANCES WILL TREX BE LIABLE FOR INCIDENTAL OR CONSEQUENTIAL DAMAGES, WHETHER SUCH DAMAGES ARE SOUGHT IN CONTRACT, IN TORT (INCLUDING BUT NOT LIMITED TO NEGLIGENCE AND STRICT LIABILITY) OR OTHERWISE, AND TREX’S LIABILITY FOR NON-PERSONAL INJURY CLAIMS WITH RESPECT TO DEFECTIVE PRODUCTS SHALL IN NO EVENT EXCEED THE REPLACEMENT OF SUCH PRODUCTS OR REFUND OF THE PURCHASE PRICE, AS DESCRIBED ABOVE.**

Some States or Provinces do not allow the exclusion or limitation of incidental or consequential damages, so the above limitation or exclusion may not apply to you. This warranty gives you specific legal rights, and you may also have other rights that vary from State to State or Province to Province.

Copyright © 2018 Trex Company, Inc.



 @TrexCompany

**Share your build**

Tag your snaps with #trexdecking  
to be featured in our feed.

GET STARTED  
WITH OUR HELPFUL

## Online Tools

### INSPIRATION & IDEAS

Enjoy photos, tips and testimonials  
at [trex.com/ideas](http://trex.com/ideas)

### COLOR SELECTOR

Find a hue that says “you”  
at [trex.com/colors](http://trex.com/colors)

### COST CALCULATOR

Estimate the price of your  
deck at [trex.com/costs](http://trex.com/costs)

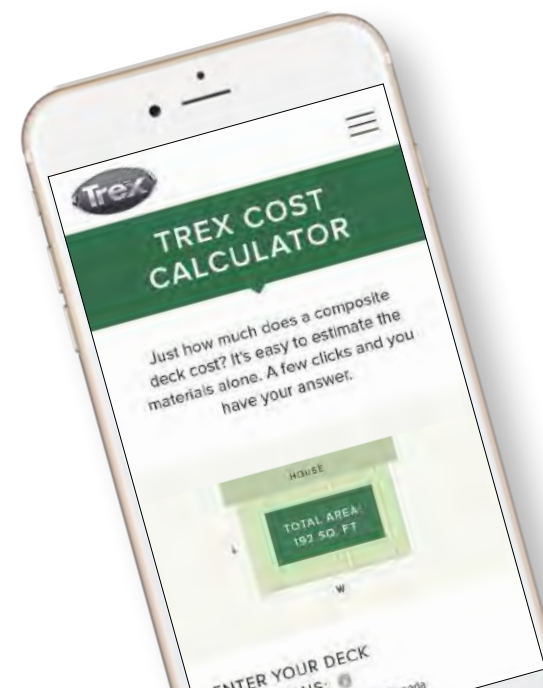

### BOARD SAMPLES

Compare and contrast footlong  
boards at [shop.trex.com](http://shop.trex.com)

### DECKING & RAILING DUOS

Select a pre-styled pairing  
at [trex.com/duos](http://trex.com/duos)

### DECK STARTER

Design your deck in three clicks  
at [trex.com/getstarted](http://trex.com/getstarted)

### TREX LOCATOR

Find nearby retailers at  
[trex.com/locations](http://trex.com/locations)

### TREXPRO®

Find a local, pre-approved  
contractor at [trex.com/findapro](http://trex.com/findapro)





FRONT/BACK  
decking: Transcend in Vintage Lantern  
railing: Signature Rod Rail in Charcoal Black

DECKING | RAILING | FRAMING | LIGHTING | FASCIA | KITCHENS | FURNITURE | PERGOLA | DRAINAGE



Engineering What's Next  
in Outdoor Living®

FIND US ON



Visit **trex.com** or call **1-800-BUY-TREX**

© 2019 Trex Company, Inc. All rights reserved. Trex®, the Trex logo, TrexPro®, Trex Enhance®, Trex Select®, Trex Transcend®, Trex® Cladding™, Trex Signature®, Trex Elevations®, Trex® OutdoorLighting™, Trex® Fascia, Trex® Pergola™, Trex® Outdoor Kitchens™, Trex® Spiral Stairs™, Trex® RainEscape®, Trex® Protect™, Trex® Outdoor Furniture™, Trex® Cornhole™, Trex® LatticeWorks™, Trex Hideaway®, Trex LightHub® and Trex Reveal® are either federally registered trademarks, trademarks or trade dress of Trex Company, Inc., Winchester, Virginia or its licensees.

Front and Back Cover Photos © 2018 Scripps Networks, LLC. Used with permission; all rights reserved.